

RoHS

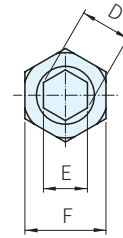

STM13

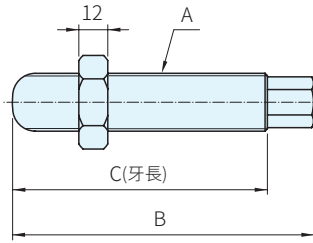
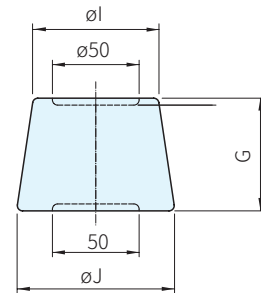
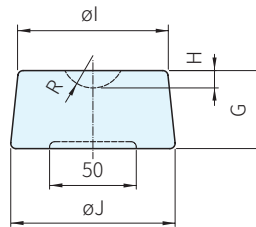
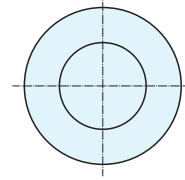
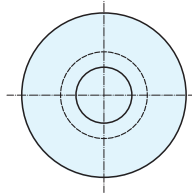

STM14-11  
STM14-12

STM14-13

TYPE	材質	處理	顏色
STM13	S45C	正常化、皮膜處理	-
STM14	FC30	噴漆	黃

調整螺栓(螺絲) 品號	A	B	C	D	E	F	庫存
STM13-11	M25×2	90	70	22	19	35	·
STM13-12		130	110				·
STM13-21	M30×2	90	70	28	24	46	·
STM13-22		130	110				·
STM13-31	M36×2	90	70	34	30	46	·
STM13-32		130	110				·

腳座 品號	G	R	H	I	J	庫存
STM14-11	25	18	5	86	91	·
STM14-12	45		10	88	96	·
STM14-13	65	-	-	72	91	·

**PS. 備註**

- 水平調整螺栓加黃油使用，可減輕旋轉扭力
- 精密型螺栓可接受訂製
- 腳座顏色亦可提供紅、白、黑 歡迎洽詢
- STM14-13螺栓定位孔可追加加工，請附圖面

**Ex. 使用例**

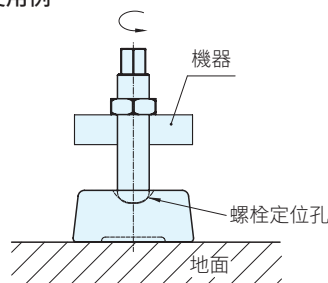

訂貨：  交期：  天

STM13-11