

材質	處理
鋼	染黑
SUS	-

一字溝

內六角

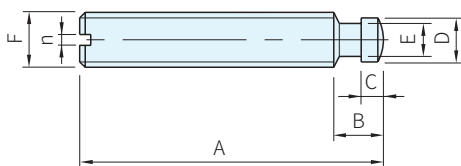

22560.0012-.0040(鋼)
22560.0112-.0140(不銹鋼)

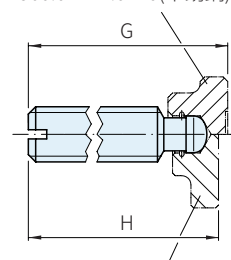

22560.0425-.0440(鋼)
22560.1425-.1440(不銹鋼)

鋼				不銹鋼				A	B	C	D (h11)	E	F	WS	n	G	H	質量 (g)			
一字溝		內六角		一字溝		內六角												一字溝		內六角	
品號	庫存	品號	庫存	品號	庫存	品號	庫存														
22540.0061	·	22540.0361	·	22540.1061	·	22540.1361	·	30	6.0	2.5	4.5	4.0	M6×1	3	1.0	32.1	-	4.5	4.3		
22540.0062	·	22540.0362	·	22540.1062	·	22540.1362	·	50										52.1	7.8	7.6	
22540.0081	·	22540.0381	·	22540.1081	·	22540.1381	·	40	7.5	3.0	6.0	5.4	M8×1.25	4	1.2	43.0	42.5	11.0	11.0		
22540.0082	·	22540.0382	·	22540.1082	·	22540.1382	·	60								63.0	62.5	17.0	17.0		
22540.0101	·	22540.0401	·	22540.1101	·	22540.1401	·	60	9.0				M10×1.5	5	1.6	63.6	62.6	27.0	26.0		
22540.0102	·	22540.0402	·	22540.1102	·	22540.1402	·	80								83.6	82.6	37.0	36.0		
22540.0121	·	22540.0421	·	22540.1121	·	22540.1421	·	60	10.0	4.5	8.0	7.2	M12×1.75	6	2.0	64.6	62.6	38.0	36.0		
22540.0122	·	22540.0422	·	22540.1122	·	22540.1422	·	80								84.6	82.6	51.0		50.0	
22540.0123	·	22540.0423	·	22540.1123	·	22540.1423	·	100								104.6	102.6	65.5	64.0		
22540.0161	·	22540.0461	·	22540.1161	·	22540.1461	·	80	12.0	5.0	12.0	11.0	M16×2	8	2.5	85.4	82.9	100.0	91.0		
22540.0162	·	22540.0462	·	22540.1162	·	22540.1462	·	100								105.4	102.9	126.0	118.0		
22540.0163	·	22540.0463	·	22540.1163	·	22540.1463	·	125								130.4	127.9	160.0	150.0		
22540.0201	·	22540.0501	·	22540.1201	·	22540.1501	·	100	14.0	5.5	15.5	14.4	M20×2.5	10	3.0	105.5	-	190.0	182.0		
22540.0202	·	22540.0502	·	22540.1202	·	22540.1502	·	125								130.5	-	240.0	233.0		
22540.0203	·	22540.0503	·	22540.1203	·	22540.1503	·	150								155.5	-	290.0	284.0		

Wa 注意

· 本產品和 22560 (本單元)
SGR6311.1 (本單元) 結合使用

Ex 使用例

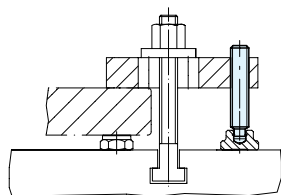
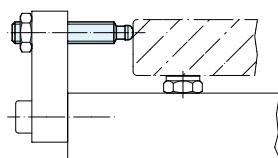

訂貨： 交期：

22540.0061