

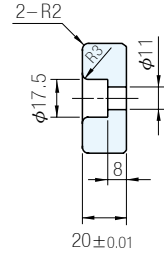

SESWW  
(2孔形)

W=28~75

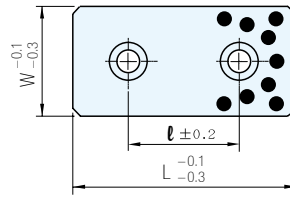

SESWW  
(4孔形)

W=100以上

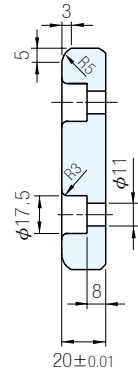
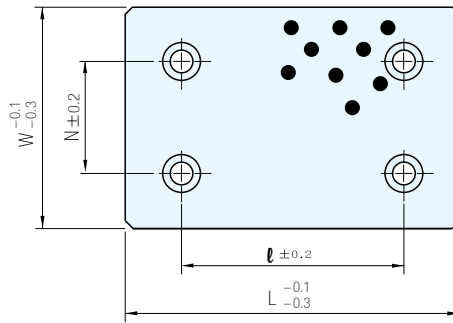

材質  
銅合金+固體潤滑劑



SESWTT  
(2孔形)

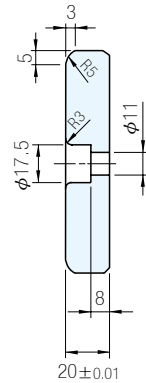
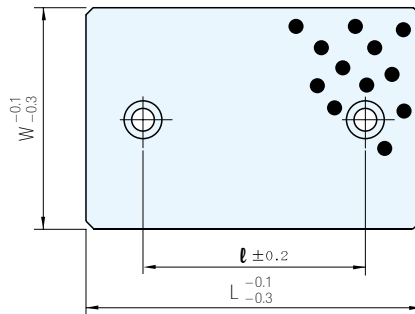

滑動方向  
W=28 · 38

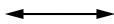

W=48以上

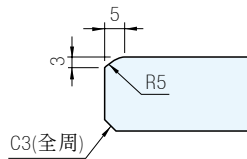
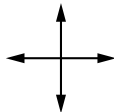

(兩端部R倒角形狀)

ℓ	N	品 號	W	L	單 價		
		TYPE					
45	-	SESWW (2孔形)	28	75	·		
50				100			
75				125			
100				150			
150				200			
45			-	SESWW (2孔形)	38	75	·
50						100	
75						125	
100						150	
150						200	
45			-	SESWW (2孔形)	48	75	·
50						100	
75						125	
100						150	
150						200	
45	-	SESWW (2孔形)	58	75	·		
50				100			
75				125			
100				150			
150				200			
25	-	SESWW (2孔形)	75	75	·		
50				100			
75				125			
100				150			
150				200			
50			-	SESWTT (2孔形)	100	100	·
75						125	
100						150	
150						200	
200						250	
75	-	SESWTT (2孔形)	125	125	·		
100				150			
150				200			
200				250			
250				300			
100	-	SESWTT (2孔形)	150	150	·		
150				200			
200				250			
250				300			
50				50		SESWW (4孔形)	100
75	125						
100	150						
150	200						
200	250						
75	50	SESWW (4孔形)	125	125	·		
100				150			
150				200			
200				250			
100				100		SESWW (4孔形)	150
150	200						
200	250						
250	300						
150	150	SESWW (4孔形)	200		200		
200				250			
250				300			

訂貨：品 號 [ W ] - [ L ] 交 期： [ 5 ] 天

SESWW 28 - 75