

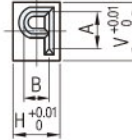

GES 鍵槽型

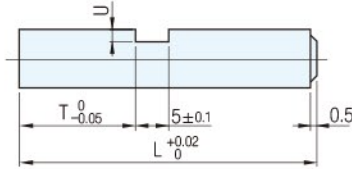

鍵槽位置K



GEK 單邊肩型

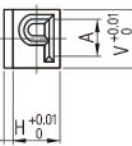
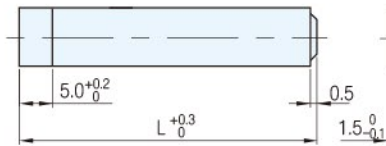

肩型位置F

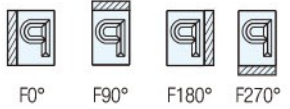

GEN 螺紋固定型

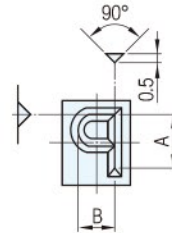
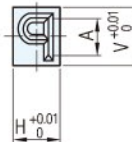
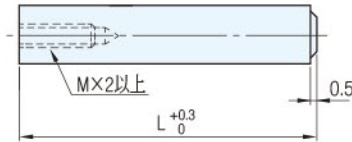

材質	硬度
相當於SKH51	59~62HRC

U	M	V	H	B	Catalog No.		指定單位0.1mm	指定單位0.1mm	文字(粗體)
					TYPE	A	L	T	CHR
1.0	-	5	4	2	GES	3	16.0~60.0	2 ≤ T < L	0 1 2 3 4 5 6 7 8 9 A B C D E F G H I J K L M N O P Q R S T U V W X Y Z
		6	5	2.7		4	16.0~70.0		
-	-	5	4	2	GEK	3	16.0~60.0	-	
		6	5	2.7		4	16.0~70.0		
		8	6	3.4		5	16.0~70.0		
-	3	6	5	2	GEN	3	16.0~60.0	-	
				2.7		4	16.0~70.0		
		4	8	6		3.4	5		

Wa 注意

• GES不要鍵槽時,請指定T尺寸與全長L相同→T=L

訂貨: Catalog No. - L - T - CHR No. - K.F - (VKC, HKC) 交期: 7 天

GES3	- 48.0 - T15.0 -	P - K0
GEK3	- 25.0 -	L - F90
GEN3	- 55.0 -	I
GES3	- 55.0 - T15.0 -	A - K0 - HKC

Ex 使用例

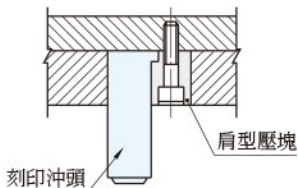

追加加工

Alteration	Code	Spec.
	VKC	變更V尺寸公差 V ^{+0.01} → V _{-0.01} ⁰
	HKC	變更H尺寸公差 H ^{+0.01} → H _{-0.01} ⁰

刻印方型沖頭	字體
GES	0 1 2 3 4 5 6 7 8 9 A B C D E F G H I J K L M N O P Q R S T U V W X Y Z
GEK	
GEN	
GEN□M	
GES□M	
GEK□M	
GEN□M	