

RoHS

①圓形用

①異形用

②

③

④

⑤



圓形沖頭 ·
 圓形下模用

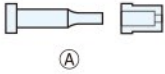

①

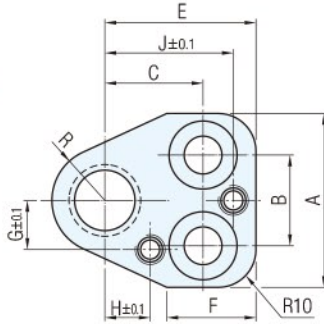

②

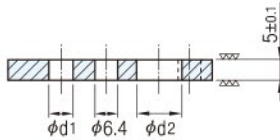

①

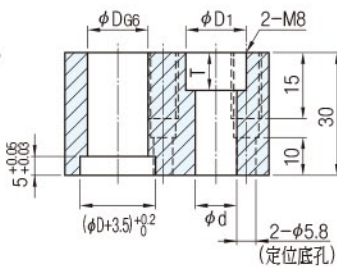

異形沖頭 ·
 異形下模用

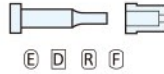

① ② ③ ④ ⑤

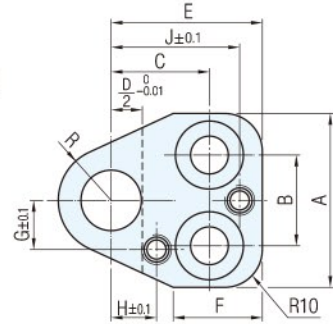

②

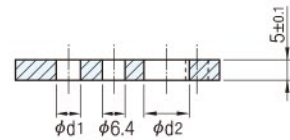

①

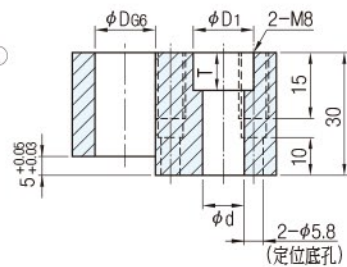

零件	材質	硬度	表面處理
①	S45C	-	Fe ₃ O ₄
②	相當於SCM440	56~60HRC	-
③	內六角螺栓	-	-

	Catalog No.		構成零件				
	圓形用	異形用	①	②	③	④	⑤
沖頭用	ES-WS	ES-KS	•	•	•	•	•
	ESWQ	ESKQ	•	•	•	•	•
	TSE	TSE		•			
下模用	ES-WL	ES-KL	•	•	•	•	•
	TLE	TLE		•			
本體	ES-WM	ES-KM	•				

Catalog No.		D	D _{G6}	A	B	C	E	F	G	H	J	R	D ₁	d	T	d ₂	d ₁		圓形用附件 ③④⑤	異形用附件 ③④⑤
TYPE																	TSE	TLE		
圓形用 ①②③④⑤	異形用 ①②③④⑤	10	+0.014 +0.005	37	20	21	35		10	9	29	9.5	14	9	10	10		7.4	③M8-40 ④NPBN6-30 ⑤NSW8	③M8-40 ④NPBN6-30 ⑤NSW8
ES-WS	ES-KS	13	+0.017	43	26	23	38		13		11	32	12.0					9.4		
ES-WL	ES-KL	16	+0.006	44	24	26	40				12	34	14.0							
ESWQ	ESKQ	20	+0.020	48	28	27	42	20	16	14	36	17.0	17	11	12	12	6.2	11.6	③M10-40 ④NPBN6-30 ⑤NSW8	③M10-40 ④NPBN6-30 ⑤NSW8
		25	+0.007	50		30	46		18	17	39	19.5						13.6		
TSE	TSE	32		54	30	33	48		21	20	42	23.0						17.6		
TLE	TLE	38	+0.025 +0.009	58		35	52		23	23	46	26.0	19	13	14	14	10.2	21.6	③M12-40 ④NPBN6-30 ⑤NSW8	③M12-40 ④NPBN6-30 ⑤NSW8
ES-WM	ES-KM	45		64	34	38	56		26	27	50	29.5						27.6		
																		37.0		

訂貨：Catalog No. 交期：6 天

ES-WS 10