

RoHS

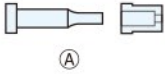

圓形沖頭 ·
圓形下模用



①

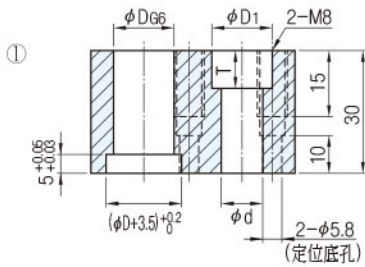
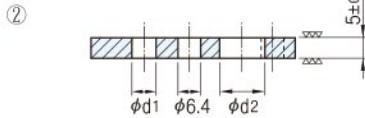
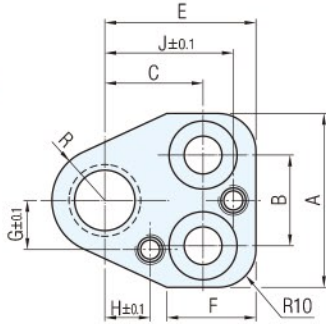

異形沖頭 ·
異形下模用

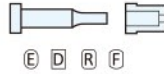

① ② ③ ④ ⑤

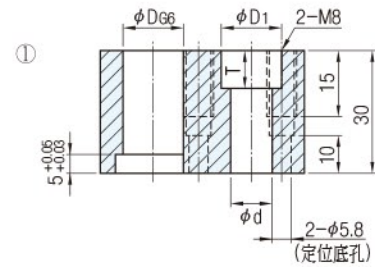
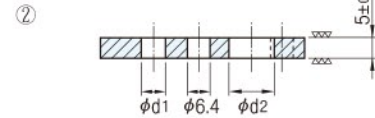
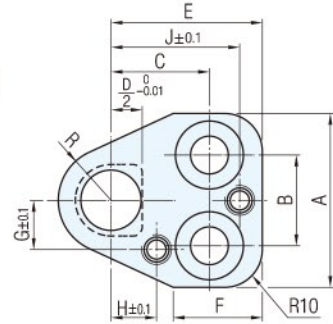

零件	材質	硬度	表面處理
①	S50C	-	Fe ₃ O ₄
②	S50C	56~60HRC	-
③	內六角螺栓		

	Catalog No.		構成零件				
	圓形用	異形用	①	②	③	④	⑤
沖頭用	ER-AL	ER-BL	•	•	•	•	•
	ERAR	ERBR	•	•	•	•	•
	EBPL	EBPL	•	•			
下模用	ER-AD	ER-BD	•	•	•	•	•
	EBDL	EBDL	•				
本體	ER-AN	ER-BN	•				

Catalog No.		D	DG6	A	B	C	E	F	G	H	J	R	D1	d	T	d2	d1		圓形用附件 ③④⑤	異形用附件 ③④⑤
TYPE																	EBPL	EBDL		
圓形用	異形用	10	+0.014 +0.005	37	20	21	35		10	9	29	9.5	14	9	10	10	6.2	7.4	③M8-40	③M8-40
ER-AL	ER-BL																	9.4	④NPBN6-30	④NPBN6-30
ER-AD	ER-BD	13	+0.017	43	26	23	38		13		12	34	12.0					⑤NSW8	⑤NSW8	
(①③④⑤)		16	+0.006	44	24	26	40				12	34	14.0							
ERAR	ERBR	20	+0.020	48	28	27	42	20	16	14	36	17.0	17	11	12	12		11.6	③M10-40	③M10-40
(②)		25	+0.007	50		30	46		18	17	39	19.5						13.6	④NPBN6-30	④NPBN6-30
EBPL	EBPL	32		54	30	33	48		21	20	42	23.0						17.6	⑤NSW8	⑤NSW8
EBDL	EBDL	38	+0.025 +0.009	58		35	52		23	23	46	26.0	19	13	14	14		21.6	③M12-40	③M12-40
(①)		45		64	34	38	56		26	27	50	29.5						27.6	④NPBN6-30	④NPBN6-30
ER-AN	ER-BN																	37.0	⑤NSW8	⑤NSW8

訂貨： Catalog No. 交期： 1 天

DR-AL 10