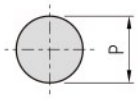
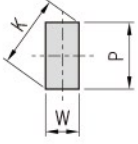
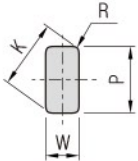
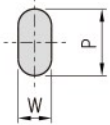
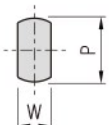

形狀	刃口的輪廓長ℓ	對角線(外接圓)K	斷面積S	
A		πP	P	$\pi P^2/4$
D		$2(P+W)$	$\sqrt{P^2+W^2}$	PW
R		$2(\pi R+P+W-4R)$	$2R+\sqrt{(P-2R)^2+(W-2R)^2}$	$PW-(4R^2-\pi R^2)$
E		$\pi W+2(P-W)$	P	$\frac{\pi}{4} W^2+W(P-W)$
G		$2\sqrt{P^2-W^2}+(\pi P\sin^{-1}W/P)/90$	P	$\pi P^2/4-(\pi P^2-\cos^{-1}W/P)/360+W/2\sqrt{P^2-W^2}$

■ R部長(Y)的計算式

①沖頭R部分長度(Y)

$$X=(D-P)/2$$

$$Y=\sqrt{X(20-X)} \cdots \cdots R=10$$

$$Y=\sqrt{X(2R-X)} \cdots \cdots R \neq 10 \text{ 以外}$$

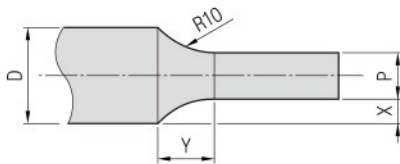

②導位沖頭R部分長度(Y)

$$Y=\sqrt{P(10-P/4)} \cdots \cdots R=10$$

$$Y=\sqrt{P(R-P/4)} \cdots \cdots R \neq 10 \text{ 以外}$$

• P<8の場合

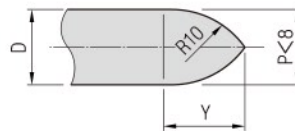

• P≥8時, Y=8

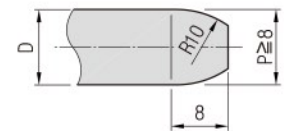

例1)PSAS10-60-P4.8

$$X=(D-P)/2=(10-6.8)/2$$

$$=1.6$$

$$Y=\sqrt{1.6(20-1.6)} \approx 5.426$$

例2)PSB5-20-P4.5

$$Y=\sqrt{P(10-P/4)}$$

$$=\sqrt{4.5(10-4.5/4)} \approx 6.32$$