

RoHS

圖 1(鉚合)



圖 2(螺栓)



圖 3(孔型)

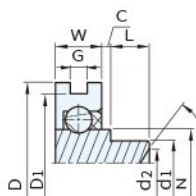

圖 4(螺栓)

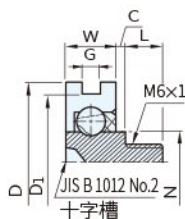

圖 5(螺栓)

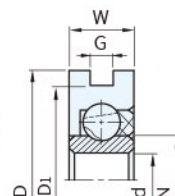

圖 6(孔型)

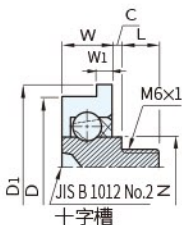

外輪	POM
軸承	鋼

品號	備註	D ±0.2	D1 ±0.2	d +0.1 0	d1 0 -0.1	W 0 -0.2	C ±0.4	L ±0.2	d2×θ*1	G ±0.2	N	庫存
K-DH-16-A0.5	圖1	19	16	-	5	6	0.5	3.5	ø4×120°	2.1	8.2	
K-DH-16-B0.5	圖2						1					
K-DH-16-B1												
K-DH-19-B0.5-2	圖2	22	19	-	-	7	0.5	8±0.5		2	9.5	
K-DH-21-B0.5-2		24	21									
K-DH-16-H5	圖3	19	16	5	-	6	-	-		2.1	8.2	
K-DH-19-H6-2		22	19	6		7				2		
K-DH-19-H6-2.5		2.5										
K-DH-21-H6-2		2	9.5									
K-DH-21-H6-3		3										
K-DH-21-H6-3.2		3.2										

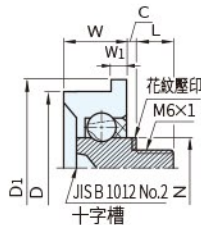
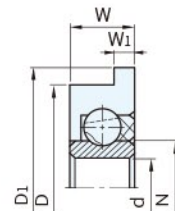
品號	備註	D 0 -0.1	D1 ±0.2	d +0.1 0	W 0 -0.2	W1 ±0.2	C ±0.4	L ±0.5	N	外輪荷重 N	軸承荷重 N	庫存
K-DF-17-B0.5	圖4	17	19	-	6	1	0.5	8	8.2	49	-	
K-DF-22-B0.5		22	26		7	2						
K-DF-26-B1	圖5	26±0.2 32		-	11±0.2	3	1	-	9.5	196	-	
K-DF-26-B2		2										
K-DF-17-H6	圖6	17	19±0.1	6	6	1±0.1	-	-	8.2	49	14.7	
K-DF-19-H6		19	22		7	1.5						
K-DF-22-H6		22	26		2	2						
K-DF-23-H10		23	24.75	10	8±0.2	1.5±0.1	-	-	13.0	98	39.2	
K-DF-30-H10-3		30	34		8.5±0.2	3						
K-DF-32-H12		32	36		10							

【Ps.】備註

- 溫度範圍：0°C~40°C
- 滾輪請勿施予軸向荷重
- 容許荷重是本公司300RPM/100萬回的測試值
- 1N=0.101972kgf
- \*1是參考值

【Wa.】注意

· 非庫存品必須以101pcs為單位購買之

訂貨：  交期：  天 庫存

K-DF-22-B0.5

其它