

- 1
- 2
- 3
- 4
- 5
- 6
- 7
- 8
- 9
- 10
- 11
- 12
- 13
- 14
- 15
- 16
- 17
- 18
- 19

**MATERIAL**

Glass-fibre reinforced polyamide based (PA) technopolymer, black colour, matte finish.

**PACKING RING**

NBR synthetic rubber.

**ANTI-SPLASH DISC**

Glass-fibre reinforced polyamide based (PA) technopolymer, black colour, matte finish.

**MAXIMUM CONTINUOUS WORKING TEMPERATURE**

100°C.

**GRAPHIC SYMBOL "FILL"**

According to DIN regulations.

**TECHNICAL DATA**

The tightening torque indicated in the table guarantees an optimal tightness, keeping the packing ring in the correct position.

**ACCESSORIES ON REQUEST**

The threaded caps can be customised with aluminium labels with marks and symbols MH. (see page 1146).



ELESA Original design

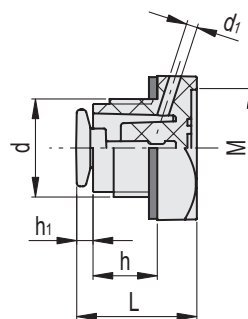
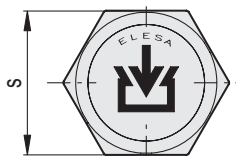
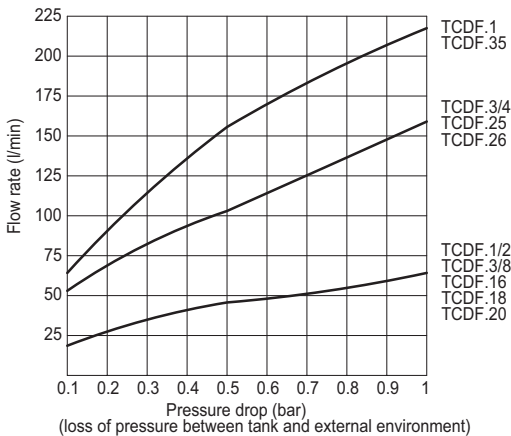

Code	Description	s	d	h	L	M	d1	h1	Tightening torque [Nm]	⚖️
58688	TCDF.16x1.5+P	22	M16x1.5	9	19	17	2	3.5	8+10	6
58689	TCDF.18x1.5+P	26	M18x1.5	11	21.5	20.5	2	3	8+10	9
58690	TCDF.20x1.5+P	26	M20x1.5	11	21.5	20.5	2	3.5	8+10	10
58692	TCDF.25x1.5+P	32	M25x1.5	12	25	25	3.5	4.5	10+12	15
58693	TCDF.26x1.5+P	32	M26x1.5	12	25	25	3.5	4.5	10+12	15
58694	TCDF.35x1.5+P	38	M35x1.5	13	26	31	3.5	4	15+18	20
58695	TCDF.3/8+P	22	G 3/8	9	19	17	2	3.5	8+10	6
58696	TCDF.1/2+P	26	G 1/2	11	21.5	20.5	2	3.5	8+10	10
58697	TCDF.3/4+P	32	G 3/4	12	25	25	3.5	4.5	10+12	15
58698	TCDF.1+P	38	G 1	13	26	31	3.5	4.5	12+15	23