



MATERIAL

Phenolic based (PF) Duroplast chrome-plated, glossy finish.
White pad-printed index line, placed at 180° from the transversal grub screw.

STANDARD EXECUTION

Plain blind hole, assembly by means of a trasversal grub screw according to UNI 5929-85 in AISI 304 stainless steel (grub screw with hexagonal socket and cup end) which screws into the AISI 304 stainless steel nut.
Supplied.

FEATURES

A limited manoeuvre angle is possible by fitting stop pins in the rear guide slot.



ELESA Original design

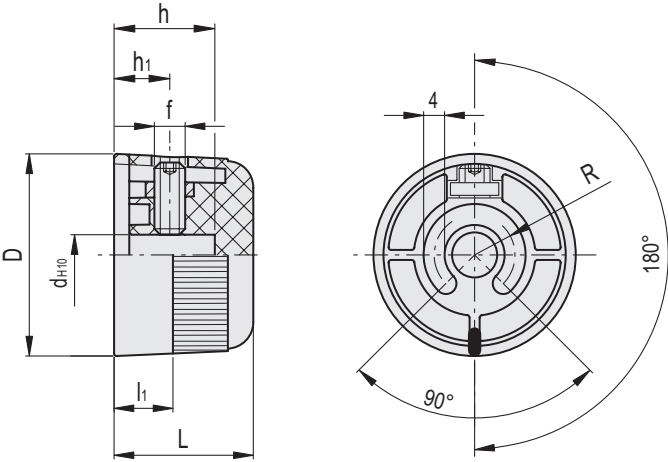

Code	Description	D	dH10	L	l1	h	h1	f	R	
152861	MI.304/35-CR N-6	35	6	24.5	10	18	11	M5	6.2	21
152863	MI.304/40-CR N-8	40	8	27.5	11.5	20	11	M5	8	30
152865	MI.304/45-CR N-8	46	8	29.5	12.5	21.5	11	M5	8.4	41