

- 1
- 2
- 3
- 4
- 5
- 6
- 7
- 8
- 9
- 10
- 11
- 12
- 13
- 14
- 15
- 16
- 17
- 18

MATERIAL

Glass-fibre reinforced polyamide based (PA) SUPER-technopolymer, black colour.

FEATURES AND APPLICATIONS

- Anti-rust.
- Resistance to chemical agents (see table).
- Can also be used in outdoor conditions with excellent durability.
- High mechanical resistance.
- Lightness: suitable for applications that require reduced weight.
- Cost-effective solution (see graph).



CHEMICAL AGENTS	SM-SST Stainless steel AISI 304	SM Zinc-plated steel	STP SUPER- technopolymer
HYDROCARBONS, OILS AND FATS	●	●	●
WEAK BASES	●	●	●
SOLVENTS	●	△	●
WEAK ACIDS	△	△	●
CHLORIDE CONCENTRATES	△	△	●
GALVANIC CORROSION	△	△	●
STRONG ACIDS	△	△	△
STRONG BASES	△	△	△
AMMONIUM CHLORIDE	●	△	●
CALCIUM CHLORIDE 5%	●	△	●
SATURATED CALCIUM CHLORIDE	△	△	△
IRON CHLORIDE (III) 5-10%	△	△	△
POTASSIUM CHLORIDE 10%	●	△	●
SODIUM CHLORIDE 10%	●	△	●
ZINC CHLORIDE 10%	△	△	△

Suitable ● Not suitable △

Indicative cost comparison of stems available in different materials (SM-SST, SM, STP)

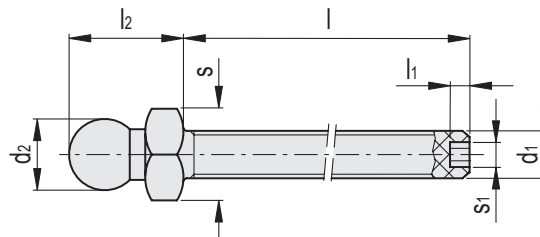
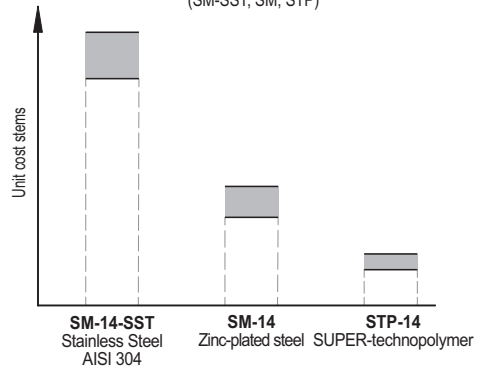

Code	Description	d1	l	l1	l2	d2	s	s1	Max. limit static load [N]	⚖️
317121	STP-14-M8x44	M8	44	3	21	14	14	3	2700	8
317125	STP-14-M8x69	M8	69	3	21	14	14	3	2700	9.5
317221	STP-14-M10x44	M10	44	3	21	14	14	4	4800	9.5
317225	STP-14-M10x69	M10	69	3	21	14	14	4	5000	12
317231	STP-14-M10x99	M10	99	3	21	14	14	4	5100	15
317321	STP-14-M12x44	M12	44	4	21	14	14	5	6800	11
317325	STP-14-M12x69	M12	69	4	21	14	14	5	7000	15
317331	STP-14-M12x99	M12	99	4	21	14	14	5	7000	19.5