



Kwik-Lok® Marine Pins Heavy Duty Detent



The Heavy Duty Detent Kwik-Lok® Pin is a high quality shoulder style alignment pin for applications that don't require the positive locking ball feature.

- Heavy duty spring and 2 spring loaded stainless steel locking balls provide high pull out force
- Includes split ring for easy attachment of optional lanyard
- 300 Series Stainless steel handle and body

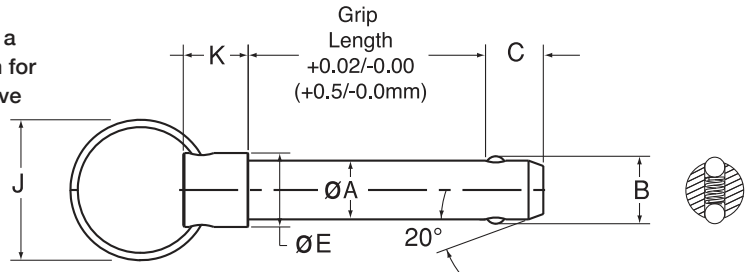

Heavy Duty Detent Specifications – Inch

DIA	A +0.00 / -0.003	B MIN	C +0.00 / -0.06	E DIA +/-0.15 / -0.04	J DIA	K	Double Shear Strength - (lbs) Stainless 17-4 PH	Pull Out Force (lbs)	Recommended Hole Dia	
									MAX	MIN
3/16 (#10)	0.1885	0.200	0.250	0.375	1.187	0.50	5,262	2 to 7	0.1940	0.1900
1/4	0.2480	0.280	0.344	0.375	1.187	0.50	9,537	2 to 7	0.2540	0.2500
5/16	0.3105	0.360	0.359	0.438	1.187	0.50	15,075	2 to 7	0.3165	0.3125
3/8	0.3730	0.430	0.390	0.500	1.187	0.50	22,050	6 to 14	0.3790	0.3750
1/2	0.4980	0.570	0.516	0.625	1.187	0.55	39,263	10 to 22	0.5050	0.5000
5/8	0.6230	0.720	0.672	0.750	1.687	0.55	61,736	15 to 30	0.6300	0.6250
3/4	0.7480	0.860	0.750	0.875	1.687	0.55	88,442	15 to 30	0.7570	0.7500

Pin Dia	Grip Length (In)											
	0.5	0.75	1	1.25	1.5	1.75	2	2.5	3	4	5	
PART NUMBERS	3/16	883800	883801	883802	883803	883804	883805	883806	883808	883809	-	-
	1/4	883816	883817	883818	883819	883820	883821	883822	883824	883825	883827	-
	5/16	883832	883833	883834	883835	883836	883837	883838	883840	883841	883843	-
	3/8	883848	883849	883850	883851	883852	883853	883854	883856	883857	883859	883861
	1/2	883880	883881	883882	883883	883884	883885	883886	883888	883889	883891	883893
	5/8	883912	883913	883914	883915	883916	883917	883918	883920	883921	883923	883925
	3/4	883928	883929	883930	883931	883932	883933	883934	883936	883937	883939	883941

Contact customer service for other sizes.

May be ordered with 4 locking balls for additional locking element tensile strength.
Special Materials, grip length and longer "C" dimensions upon request.