

**GN 321**

Plain, Rim Polished

**GN 323**

Black, Powder Coated

**Disk Handwheels**

Aluminum

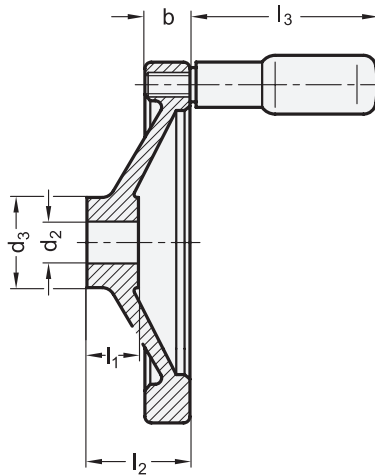
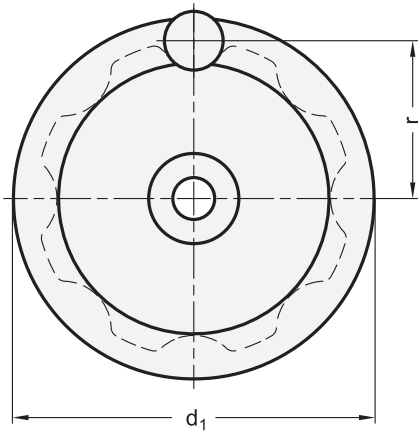
**2 Bore code**

- B** Without keyway
- K** With keyway

**4 Type**

- A** Without handle
- R** With revolving handle

**1****3**

$d_1$	$d_2$ H7 Bore		$d_3$	$b$	$l_1$	$l_2 \approx$	$l_3 \approx$	$r$	$\emptyset$ Handle GN 798
80	10	12	26	13	16	26	44	33,5	16
100	10	12	28	14	17	30	58,5	42,5	18
125	12	14	31	15	18	33	61,5	54	22
140	14	16	36	16,5	19	36	76,5	61	24
160	14	16	36	18	20	39	76,5	71	24
200	18	20	45	20,5	24	45	86,5	89	25
250	22	26	48	23	28	51	86,5	113	25

**Specification**

- Aluminum
  - Hub machined
  - Rim turned
- Radial and axial runout of the rim < 0.4
- **GN 321**
  - Rim high-polished
  - Unmachined wheel body
  - Matte shot-blasted
- **GN 323**
  - Wheel body powder coated
  - Black, textured finish
- Revolving handles GN 798
  - Plastic, Technopolymer
  - Black, matte finish
  - Spindle steel
  - Zinc plated, blue passivated
- *Keyway P9 DIN 6885 Page 1 → Page 2078*
- *Cross Holes GN 110 → Page 2080*
- *ISO Fundamental Tolerances → Page 2151*
- **RoHS**

**Information**

Disk handwheels GN 321 / GN 323 have recessed grips at their back.

see also...

- *Safety Handwheels (Disengage the Clutch) → Page 270*
- *Countersunk Washers GN 184 (for Axial Fixing) → Page 1090*
- *Disk Handwheels GN 923 (Aluminum, Powder Coated) → Page 250*

**How to order (Rim polished)**

**GN 321-160-K16-A**

- |          |           |
|----------|-----------|
| <b>1</b> | $d_1$     |
| <b>2</b> | Bore code |
| <b>3</b> | $d_2$     |
| <b>4</b> | Type      |

**How to order (Powder coated)**

**GN 323-125-B12-R**

- |          |           |
|----------|-----------|
| <b>1</b> | $d_1$     |
| <b>2</b> | Bore code |
| <b>3</b> | $d_2$     |
| <b>4</b> | Type      |