

- 1
- 2
- 3
- 4
- 5
- 6
- 7
- 8
- 9
- 10
- 11
- 12
- 13
- 14
- 15
- 16
- 17
- 18

MATERIAL

Glass-fibre reinforced polyamide based (PA) technopolymer, grey-black colour, matte finish.

SCREW-COVERS

- ECA.B: glass-fibre reinforced polyamide based (PA) technopolymer, in Elecolors colours, matte finish.

Supplied, press-fit assembly, removable by a screwdriver. Available also as accessory sold separately (see table).

STANDARD EXECUTION

Pass-through holes for front or rear mounting by means of cylindrical-head screws with hexagon socket, hexagonal-head screws or nuts. Suggested tightening torque:
 - back mounting with plain holes: 10 [Nm]
 - front mounting with plain or tapped holes: 10 [Nm].

TECHNICAL DATA

The values F1, F2, L1 and L2 indicated in the table were obtained carried out with the appropriate dynamometric equipment under the test conditions shown in the figure with ambient temperature.

ACCESSORIES ON REQUEST

ECA.B: screw-covers in Elecolors colours (see table).



ERGOSTYLE® ELESA Original design

- C1 RAL7021
- C2 RAL2004
- C3 RAL7035
- C4 RAL1021
- C5 RAL5024
- C6 RAL3000
- C17 RAL6017

ECA.B

Code	Description	Caps for
29832-*	ECA.B2-*	EBP-L.335

* Complete with colour index (C1, ..., C17).

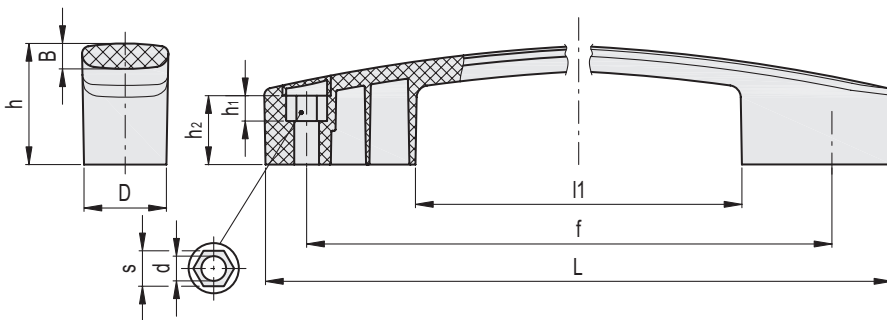
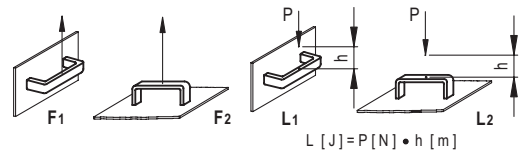

* Complete with colour index, example: 260451-C2 EBP-L.335-8-C2

- C1 RAL7021
- C2 RAL2004
- C3 RAL7035
- C4 RAL1021
- C5 RAL5024
- C6 RAL3000
- C17 RAL6017

Code	Description	L	f	d	s	D	h	h1	h2	B	l1	F1* [N]	F1# [N]	F2* [N]	F2# [N]	L1# [J]	L2# [J]	
260451-*	EBP-L.335-8-*	335	300±1	8.5	13	35.5	51	10.5	28.5	10.5	210	1000	2500	1000	5000	44	14	205
260452-*	EBP-L.335-10-*	335	300±1	10.5	17	35.5	51	10.5	28.5	10.5	210	1000	2500	1000	5000	44	14	201

* Maximum working load
 # Load at breakage.