

Plunger pin retracted

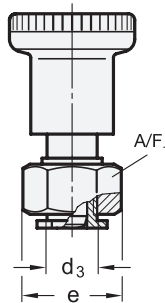

Assembly instruction

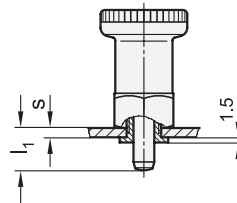

1 2

d ₁ Pin <small>-0.02 -0.05</small> Bore H7	l ₁	d ₂	d ₃	e	l ₂	l ₃	l ₄ Stroke	s Clamping distance	A/F ₁	A/F ₂	Spring load in N ≈		Axial load in N
											Initial	End	
6	8,5	25	10	19,5	34	10	6	1 ... 3	17	14	10	24	400
6	10,5	25	10	19,5	34	10	6	3 ... 5	17	14	10	24	400
8	10	31	12	22	40	12	7,5	1 ... 5	19	16	13	23	500
8	12	31	12	22	40	12	7,5	3 ... 5	19	16	13	23	500

Specification

- Guide
Steel
Zinc plated, blue passivated **ST**
- Plunger pin
Stainless steel AISI 303
Chemically nickel plated
- Knob
Plastic (Polyamide PA)
- Black, matte finish
- Not removable
- Load Rating Information → Page 2132
- ISO Fundamental Tolerances → Page 2151
- Plastic Characteristics → Page 2158
- Stainless Steel Characteristics → Page 2166
- RoHS

Accessory

- Double Ring Spanner
GN 607.9-SW14-SW16
as mounting tool

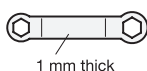

3

Information

Indexing plungers GN 607.2 have been developed for installation in thin walled equipment.

It has to be taken into consideration that, depending on the mounting plate thickness ,s', the protruding plunger length ,l₁' and the position of the hexagon nut on its centre bushing, the plunger nose might not always be fully retractable.

For design reasons the positional accuracy of this indexing plunger is not as precise as plunger GN 607.

see also...

- List of Indexing Plunger Types → Page 884 ff.
- Positioning Bushings GN 412.2 / GN 412.4 → Page 954
- Positioning Bushings with Ramping Cone GN 412.3 / GN 412.5 → Page 955

How to order

GN 607.2-6-10,5-ST

1	d ₁
2	l ₁
3	Material