

- 1
- 2
- 3
- 4
- 5
- 6
- 7
- 8
- 9
- 10
- 11
- 12
- 13
- 14
- 15
- 16
- 17
- 18

**MATERIAL**

Polyamide based (PA) technopolymer, black colour, matte finish.

**STANDARD EXECUTIONS**

Knobs BT.12,16,20 with screwdriver cut in the upper part to facilitate screwing.

- **BT-HP-p**: polished zinc-plated steel threaded stud, chamfered flat end UNI EN ISO 4753 : 2012 (see Technical data on page A-11).
- **BT-HP-SST-p**: AISI 304 stainless steel threaded stud, chamfered flat end UNI EN ISO 4753 : 2012 (see Technical data on page A-11).

**FEATURES AND APPLICATIONS**

Captive fluted knobs are used to secure blanking plates, covers, or other items without the risk of loss.

This is made possible by the non-threaded part of the stem, which allows the knob to remain anchored (captive) to the machinery.



ELESA Original design

Assembly modes

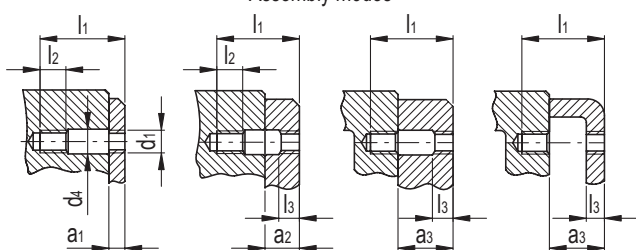

BT.12,16,20

BT.25,32

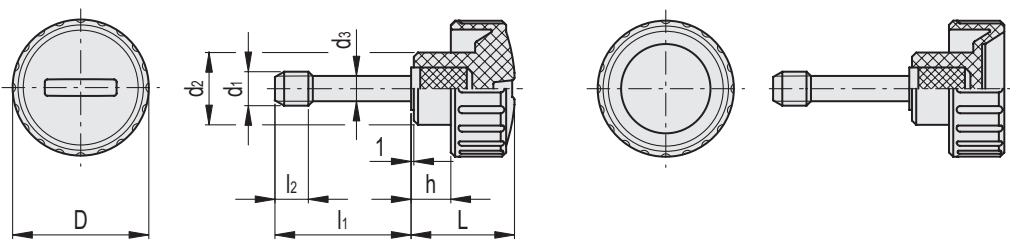

**BT-HP-p**

Code	Description	D	L	d1	d2	d3 ±0.1	d4	l1	l2	l3	h	a1	a2	a3	△
5301	BT-HP.12-p-M4x14	12	13	M4	9.5	3.1	4.5	14	5	2	4	3 + 5	6 + 10	9 + 15	4
5306	BT-HP.12-p-M4x20	12	13	M4	9.5	3.1	4.5	20	5	2	4	3 + 5	6 + 10	9 + 15	6
5311	BT-HP.16-p-M4x14	16	14	M4	11	3.1	4.5	14	5	2	5	3 + 5	6 + 10	9 + 15	5
5316	BT-HP.16-p-M4x20	16	14	M4	11	3.1	4.5	20	5	2	5	3 + 5	6 + 10	9 + 15	7
5321	BT-HP.16-p-M5x18	16	14	M5	11	4	5.5	18	6	2.5	5	4 + 6	8 + 12	12 + 18	7
5326	BT-HP.16-p-M5x24	16	14	M5	11	4	5.5	24	6	2.5	5	4 + 6	8 + 12	12 + 18	8
5331	BT-HP.20-p-M5x18	20	17	M5	11	4	5.5	18	6	2.5	6	4 + 6	8 + 12	12 + 18	9
5336	BT-HP.20-p-M5x24	20	17	M5	11	4	5.5	24	6	2.5	6	4 + 6	8 + 12	12 + 18	10
5341	BT-HP.20-p-M6x22	20	17	M6	11	4.7	6.5	22	8	3	6	5 + 8	10 + 16	15 + 24	10
5346	BT-HP.20-p-M6x32	20	17	M6	11	4.7	6.5	32	8	3	6	5 + 8	10 + 16	15 + 24	12
5351	BT-HP.25-p-M6x22	25	19	M6	16	4.7	6.5	22	8	3	8	5 + 8	10 + 16	15 + 24	13
5356	BT-HP.25-p-M6x32	25	19	M6	16	4.7	6.5	32	8	3	8	5 + 8	10 + 16	15 + 24	15
5361	BT-HP.25-p-M8x30	25	19	M8	16	6.5	8.5	30	10	4	8	7 + 10	14 + 20	21 + 30	18
5366	BT-HP.25-p-M8x40	25	19	M8	16	6.5	8.5	40	10	4	8	7 + 10	14 + 20	21 + 30	23
5369	BT-HP.32-p-M6x18	32	23	M6	17	4.7	6.5	18	8	3	9	5 + 8	10 + 16	15 + 24	15
5371	BT-HP.32-p-M6x22	32	23	M6	17	4.7	6.5	22	8	3	9	5 + 8	10 + 16	15 + 24	16
5376	BT-HP.32-p-M6x32	32	23	M6	17	4.7	6.5	32	8	3	9	5 + 8	10 + 16	15 + 24	18
5381	BT-HP.32-p-M8x30	32	23	M8	17	6.5	8.5	30	10	4	9	7 + 10	14 + 20	21 + 30	22
5386	BT-HP.32-p-M8x40	32	23	M8	17	6.5	8.5	40	10	4	9	7 + 10	14 + 20	21 + 30	27

Clamping elements

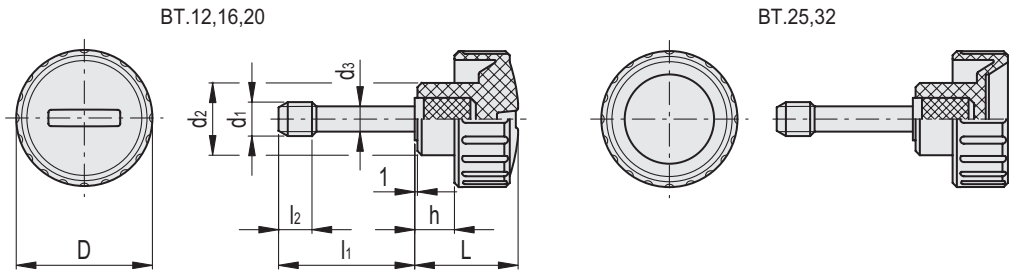

BT-HP-SST-p



Code	Description	D	L	d1	d2	d3 ±0.1	d4	l1	l2	l3	h	a1	a2	a3	⚖️
105301	BT-HP.12-SST-p-M4x14	12	13	M4	9.5	3.1	4.5	14	5	2	4	3 + 5	6 + 10	9 + 15	4
105306	BT-HP.12-SST-p-M4x20	12	13	M4	9.5	3.1	4.5	20	5	2	4	3 + 5	6 + 10	9 + 15	6
105311	BT-HP.16-SST-p-M4x14	16	14	M4	11	3.1	4.5	14	5	2	5	3 + 5	6 + 10	9 + 15	5
105316	BT-HP.16-SST-p-M4x20	16	14	M4	11	3.1	4.5	20	5	2	5	3 + 5	6 + 10	9 + 15	7
105321	BT-HP.16-SST-p-M5x18	16	14	M5	11	4	5.5	18	6	2.5	5	4 + 6	8 + 12	12 + 18	7
105326	BT-HP.16-SST-p-M5x24	16	14	M5	11	4	5.5	24	6	2.5	5	4 + 6	8 + 12	12 + 18	8
105331	BT-HP.20-SST-p-M5x18	20	17	M5	11	4	5.5	18	6	2.5	6	4 + 6	8 + 12	12 + 18	9
105336	BT-HP.20-SST-p-M5x24	20	17	M5	11	4	5.5	24	6	2.5	6	4 + 6	8 + 12	12 + 18	10
105341	BT-HP.20-SST-p-M6x22	20	17	M6	11	4.7	6.5	22	8	3	6	5 + 8	10 + 16	15 + 24	10
105346	BT-HP.20-SST-p-M6x32	20	17	M6	11	4.7	6.5	32	8	3	6	5 + 8	10 + 16	15 + 24	12
105351	BT-HP.25-SST-p-M6x22	25	19	M6	16	4.7	6.5	22	8	3	8	5 + 8	10 + 16	15 + 24	13
105356	BT-HP.25-SST-p-M6x32	25	19	M6	16	4.7	6.5	32	8	3	8	5 + 8	10 + 16	15 + 24	15
105361	BT-HP.25-SST-p-M8x30	25	19	M8	16	6.5	8.5	30	10	4	8	7 + 10	14 + 20	21 + 30	18
105366	BT-HP.25-SST-p-M8x40	25	19	M8	16	6.5	8.5	40	10	4	8	7 + 10	14 + 20	21 + 30	23
105371	BT-HP.32-SST-p-M6x22	32	23	M6	17	4.7	6.5	22	8	3	9	5 + 8	10 + 16	15 + 24	16
105376	BT-HP.32-SST-p-M6x32	32	23	M6	17	4.7	6.5	32	8	3	9	5 + 8	10 + 16	15 + 24	18
105381	BT-HP.32-SST-p-M8x30	32	23	M8	17	6.5	8.5	30	10	4	9	7 + 10	14 + 20	21 + 30	22
105386	BT-HP.32-SST-p-M8x40	32	23	M8	17	6.5	8.5	40	10	4	9	7 + 10	14 + 20	21 + 30	27



Clamping elements