

RoHS

本體		
材質	顏色	壓力角
PA塑膠	灰	20°



ZCR (圖一)(M=0.5)

ZCR (M=1)

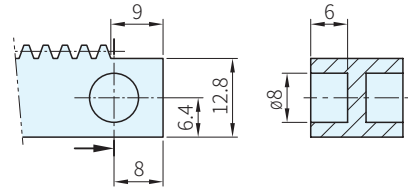
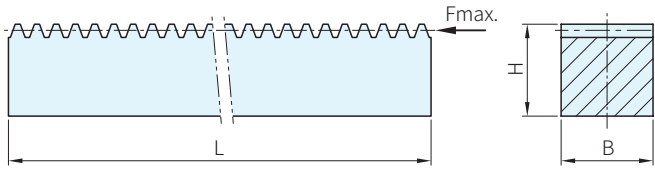

ZCR-A (圖二)(M≤3)

ZCR-A (M=4)

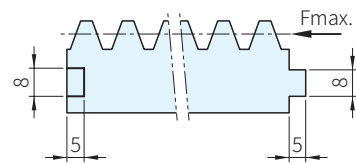
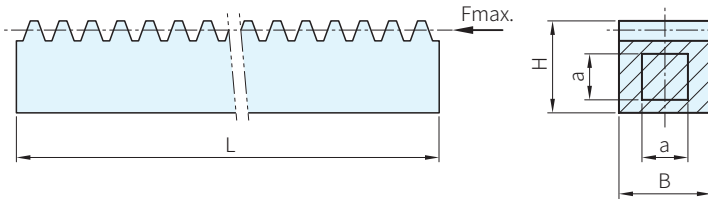

ZCR-PL (圖三)

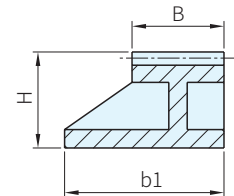
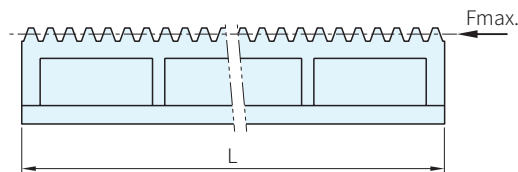

ZCR-PD (圖四)

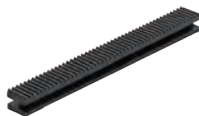
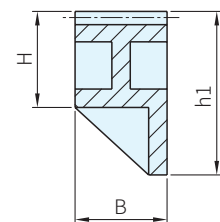
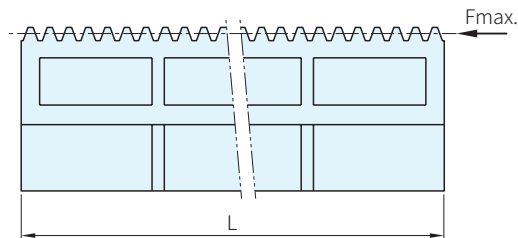

ZCR-T (圖五)

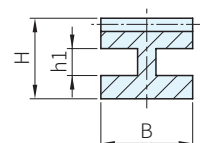
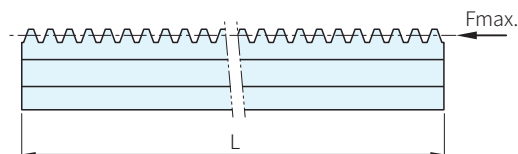

品號	備註	M 模數	L	L#	B	H	Fmax. N	質量 g
ZCR-0010	圖一	0.5	251	251	8	8	99	19
ZCR-0012		1.0	166	156	15	15	372	49
ZCR-0014		1.0	265	256	15	15	372	80

品號	備註	M 模數	L	B	H	a	Fmax. N	質量 g
ZCR-A-0010	圖二	1.0	352	15	15	8×8	372	261
ZCR-A-0012		1.5	250	17	17	8×8	633	190
ZCR-A-0014		1.5	565	17	17	8×8	633	422
ZCR-A-0016		2.0	251	20	20	10×10	993	275
ZCR-A-0018		2.0	565	20	20	10×10	993	620
ZCR-A-0020		3.0	254	30	30	15×15	2234	630
ZCR-A-0022		3.0	500	30	30	15×15	2234	1260
ZCR-A-0024		4.0	1018	20	28	10×10	1986	1250

品號	備註	M 模數	L	B	H	b1	Fmax. N	質量 g
ZCR-PL-0010	圖三	1.0	151	15	15.5	25.5	372	36
ZCR-PL-0012		1.0	248	15	15.5	25.5	372	58

品號	備註	M 模數	L	B	H	h1	Fmax. N	質量 g
ZCR-PD-0010	圖四	1.0	151	15	15.5	26.5	372	34
ZCR-PD-0012		1.0	248	15	15.5	26.5	372	55

品號	備註	M 模數	L	B	H	h1	Fmax. N	質量 g
ZCR-T-0010	圖五	1.0	151	15	13	4	372	26
ZCR-T-0012		1.0	248	15	13	4	372	42

PS. 備註

- ZCR-A：附鋼芯
- ZCR-PL：安裝面與齒條平行
- ZCR-PD：安裝面與齒條垂直
- 可依照客戶圖面加工報價服務
- 可以在齒條上做各種的加工
- 齒條如需連結，請洽詢

訂貨： 交期：

ZCR-0010