

Type APVS

Type CPVS

Type EPVS



**2 Type**

**APVS** Forked clamping arm, with two flanged washers

**CPVS** Forked clamping arm, with two flanged washers and clamping screw GN 708.1

**EPVS** Solid clamping arm, with clasp for welding

**3 Coding**

**M** Magnetic piston



Size	F <sub>H</sub> in N Holding capacity	F <sub>S</sub> in N Clamping force at 6 bar ≈	a	b <sub>1</sub>	b <sub>2</sub>	b <sub>3</sub>	b <sub>4</sub>	b <sub>5</sub>	d <sub>1</sub>	d <sub>2</sub>	d <sub>3</sub> Com-pressed air connections	Inside Ø Connection tube	e	h <sub>1</sub>	h <sub>2</sub>	h <sub>3</sub>	h <sub>4</sub> ≈
230	2200	1260	40	58	38	46	51	8,5	M 8	6,5	G 1/8	4	41,5	302	87	18	30
330	2600	1800	45	70	52,5	56	79	10,5	M 10	8,5	G 1/4	6	52,5	363	108	22	37

Size	h <sub>5</sub>	l <sub>1</sub> ≈ Type APVS Type CPVS	Type EPVS	l <sub>2</sub> ≈	l <sub>3</sub> ≈ max.	l <sub>4</sub>	m <sub>1</sub>	m <sub>2</sub>	m <sub>3</sub>	m <sub>4</sub>	m <sub>5</sub>	m <sub>6</sub>	r ≈ Type APVS Type CPVS	Type EPVS	s <sub>1</sub>	s <sub>2</sub>	s <sub>3</sub>	w Adjustable range
230	63	153	155	67	81	68	26	14	16	11	16	14,2	104	105	3	5,5	6	20
330	80	182	184	72	91	77	30	16	28	19	30	20	121	123	3,5	6,5	7	19

Type APVS

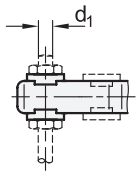

Type CPVS

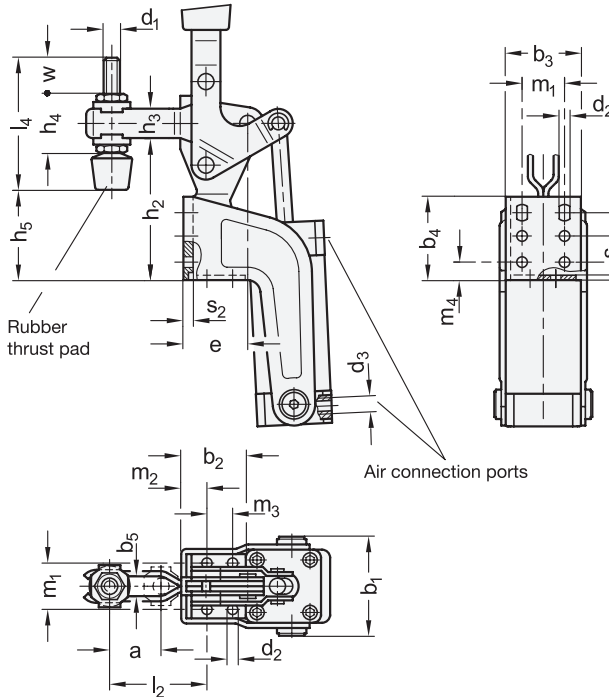

Type EPVS

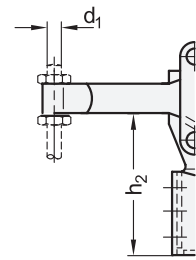

Flanged washers  
movable

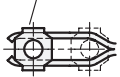

Clasp  
weldable

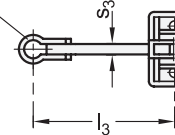

## Specification

- Sheet metal parts  
Case-hardened steel C10  
Zinc plated, blue passivated
- Bearing pins hardened
- Bearing rivets case-hardened
- Air cylinder bearing pins  
Case-hardened
- Double-action air cylinder  
Max. pressure 6 bar
- All moving parts  
Lubricated with special grease
- Solid designed plastic handle  
Red, oil resistant
- Clamping screw GN 708.1, type A
  - Steel, zinc plated, blue passivated
  - Rubber thrust pad 85 Shore A
- RoHS

## Accessory

- Clamping Screws → Page 810 ff.
- Holders for Clamping Screws GN 801  
(for Type APV3S) → Page 815
- Holders for Clamping Screws GN 809  
(for Type EPV3S) → Page 818
- Sensor GN 3380 → Page 850

## Information

Toggle clamps GN 862.1 are built from the same construction as GN 862.

The special features of these clamps are that they can be mounted in two different planes, and they can also be operated manually via the grip handle. For example, they can individually be manually closed, and then all clamps can be opened at once via the pneumatic function.

To ensure an extended life of the mechanical parts as well as the air cylinders, the operating pressure should not exceed 6 bar and a compressed air maintenance unit should be installed upstream.

Toggle clamps GN 862.1 have a permanent magnet integrated into the piston. In conjunction with sensors GN 3380, it is possible to detect the end position, such as for implementing machine controls.

see also...

- *More Information to Toggle Clamps (Pneumatic)* → Page 790

How to order

1	Size
2	Type
3	Coding

**GN 862.1-230-APVS-M**

