

- 1
- 2
- 3
- 4
- 5
- 6
- 7
- 8
- 9
- 10
- 11
- 12
- 13
- 14
- 15
- 16
- 17
- 18

**MATERIAL**

Nickel-plated steel bracket.  
Screws and centering bushings MM-CC (see page -) in black-oxide steel.

**FEATURES**

The brackets are compatible with the pneumatic fastening clamps MM-BI-NK (see page -).

**ACCESSORIES ON REQUEST**

Jaw blocks MM-SC (see page -).

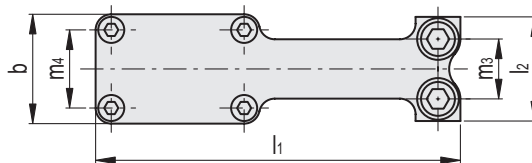
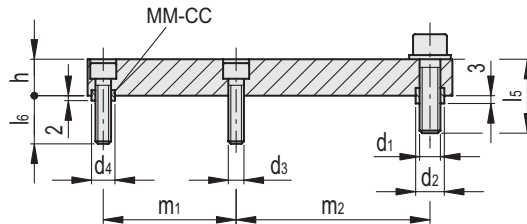
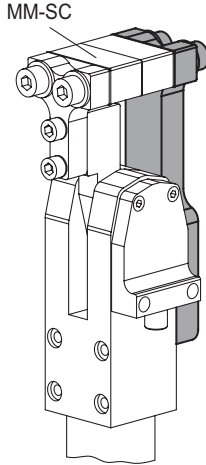

Conversion Table			
1 mm = 0.039 inch			
b		l1	
mm	inch	mm	inch
32	1.26	98.5	3.88
42	1.65	140	5.51
52	2.05	168	6.61
62	2.44	192.5	7.58

METRIC

Code	Description	b-0.2	d1	d2 H8 / h6	d3	d4 H8 / h6	h	l1	l2	l3	l4	m1	m2	m3	m4	△
MM.37020-NK	MM-FI-SC-20-NK	32	M6	9	M5	7	10	98.5	30	18.5	8	34	53	17	22	150
MM.37032-NK	MM-FI-SC-32-NK	42	M8	11	M6	9	14	140	40	23.5	8.5	51	74.4	23	30	400
MM.37040-NK	MM-FI-SC-40-NK	52	M10	13	M8	11	16	168	50	28	12.5	62	88.5	30	37	900
MM.37050-NK	MM-FI-SC-50-NK	62	M10	13	M10	13	18	192.5	60	28	12.5	71.5	102	40	44	1030

Toggle clamps