

ALUMINIUM SPRING LIFT-OFF HINGE **GS-PM120**

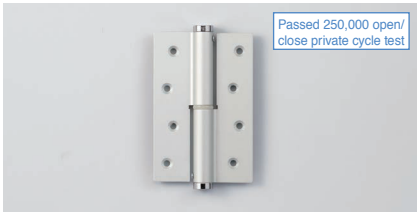

Picture above is GS-PM120-524401L.

- Spring loaded for self-closing.
- Spring tension adjustable with three steps with a hex key.
- Easy to remove the door.
- Black, white, golden or bronze colours and R10 corner rounding also available by made to order.

[Remarks]

- In case of noise, apply lubricant (grease) to washer and torsion spring.

[How to Adjust Spring Tension]

Figure below shows the case of left-hanging.

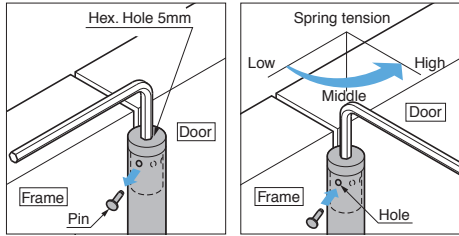

Loosen shaft with a hex key and remove the pin.

Adjust spring tension with three steps. Put the pin to the hole and fix.

[Installation]

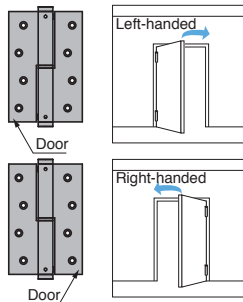

Use right-handed hinge if door is hung on the right (viewing from the side of pulling the door).

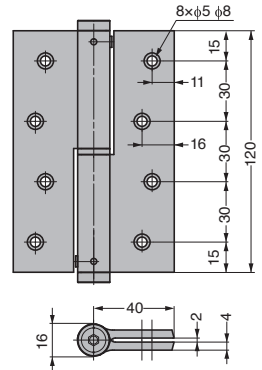

Left-handed type.

※¹ After the door is closed, leaves are not parallel to each other.

※² The value in case of door width 1000mm or less

Item Name	Type	Material	Finish	Load Capacity N/2 pcs ※ ²	Load Capacity kgf/2 pcs ※ ²	Load Capacity N/3 pcs ※ ²	Load Capacity kgf/3 pcs ※ ²	Weight (g)
GS-PM120-524401L	Left-handed	Aluminium	Anodised	200	20	300	30	172
GS-PM120-525401R	Right-handed	Alloy						

※The dimension "8× φ 5 φ 8" will change to "8× φ 5.3 φ 10" when the current stock runs out.