

# SPRING HINGE GS-ST150-6314-05



- Spring loaded for self-closing.
- Spring tension adjustable with three steps with a hex key.
- Can reduce clearance between door and frame without door cutting.
- Aluminium hinge also available by made to order.

**[Remarks]**

- In case of noise, apply lubricant (grease) to washer and torsion spring.

**[How to Adjust Spring Tension]**

Figure below shows the case of left-hanging. Right-hanging is symmetrical.

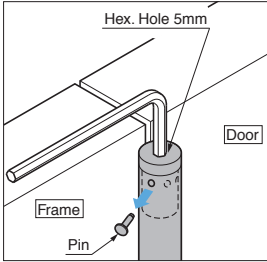

Loosen shaft with a hex key and remove the pin.

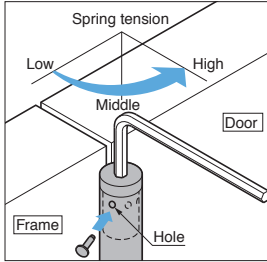

Adjust spring tension with three steps. Put the pin to the hole and fix.

**[Installation]**

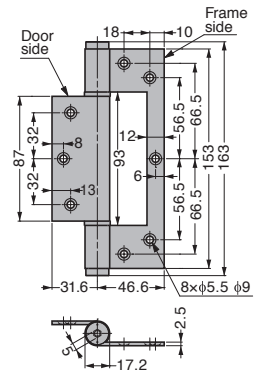
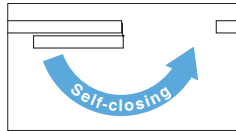
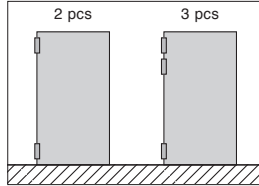

※ The value in case of door width 1000mm or less

Item Name	Material	Finish	Load Capacity N/2 pcs※	Load Capacity kgf/2 pcs※	Load Capacity N/3 pcs※	Load Capacity kgf/3 pcs※	Weight (g)
GS-ST150-6314-05	Stainless Steel (SUS304)	Plain	400	40	600	60	336