

# ADJUSTABLE SOFT-DOWN STAY GS-NSDX-35 (R/L)



Passed 30,000 open/close private cycle test

Right side installation shown.

## [Maximum Door Moment]

- With 1 stay  
Maximum door moment = 1.96~6.86 N · m
- With 2 stays, the maximum door moment will be doubled.  
Maximum door moment (N · m) = Door weight (kg) × 9.80665 × Distance from rotation centre to door centre of gravity (m)

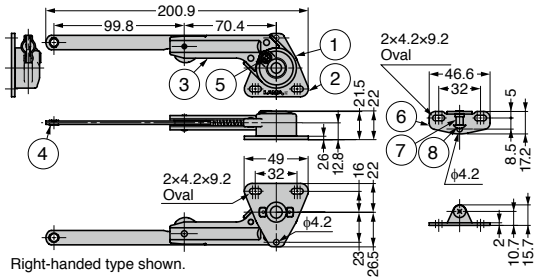

Right-handed type shown.

No.	Part Name	Material	Finish/Colour
①	Body	Zinc Alloy (ZDC)	Nickel
②	Mounting Plate	Steel (SPCC)	
③	Arm		
④	Sleeve	POM	Black
⑤	Adjustment Screw	Steel (SWCH)	Nickel
⑥	Arm Mounting Plate	Steel (SPCC)	
⑦	Shaft	Steel (SWCH)	
⑧	Truss Head Screw (M4x 5)		

## [Installation] Right side installation for upward-opening 90°.

Left side installation is symmetrical.

Comes down slowly and softly in closing direction. Installation with piano/butt hinge or concealed hinge shown below.

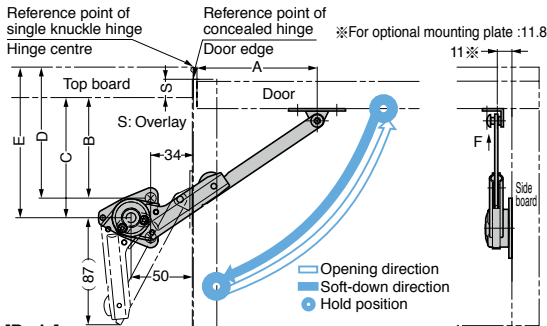

## [Body]

Item Name	Type	Material	Finish	Maximum Door Moment N · m/pc	Maximum Door Moment kgf · cm/pc	Weight (g)
GS-NSDX-35R	Right-handed	Zinc Alloy	Nickel	1.96~6.86	20~70	170
GS-NSDX-35L	Left-handed	(ZDC)/Steel				

Opening Direction	Description	Non-handed	Maximum Door Moment
Upward-opening	With Catch	-	1.96~6.86 N · m/pc (20~70 kgf · cm/pc)

- For forward-opening doors.
- Designed to hold the door in fully opened and closed position.
- Opening angle 80°, 90° or 100°.
- Closing speed adjustable with adjustment screw.
- AS parts set for installing to aluminium frame also available.

## [Specifications]

- Operating temperature: 0°C~40°C

## [Remarks]

- Be sure to read the "Cautions"
- Handed: Specific left and right-handed.
- Door closing speed varies depending on product difference and use conditions.
- Do not push the door up more than opening angle. Also do not forcibly press the door down when closing.

## [Sold Separately]

- Mounting plate
- SDS face plate and spacer for glass door (Please order when using mounting plate GS-NSDX-GZ.)

## Video Link



## Selection Tool

**Sasuga-kun**  
Applicable Products  
Used for Product Selection & Simulation.  
Available on Web!

## [Installation for Mounting Plate]

F-view (refer to "Installation")

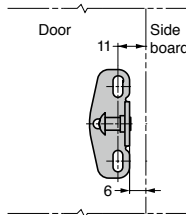

Hinge Type		A	B	C	D	E
80°	Concealed Hinge	106	105-S	121-S	-	-
	Single Knuckle Hinge	100	-	-	99	115
90°	Concealed Hinge	98	97-S	113-S	-	-
	Single Knuckle Hinge	91.5	-	-	90.5	106.5
100°	Concealed Hinge	92.5	91.5-S	107.5-S	-	-
	Single Knuckle Hinge	85	-	-	84	100

Installation dimensions vary depending on hinge type and opening angle.

- S is overlay at hinge side.
- Reference point for each dimension: hinge centre for single knuckle hinge, while door edge for concealed hinge.