

NSDX BRACKET FOR STAY GS-AS-NSDX



- Used for installing soft-down stay GS-NSDX to aluminium frame.
- Use GS-AS nuts for installation.

[Parts Included]

- GS-AS-NSDX-A: Truss head screw M4(SUS)
- GS-AS-NSDX-B: None

[How to Install]

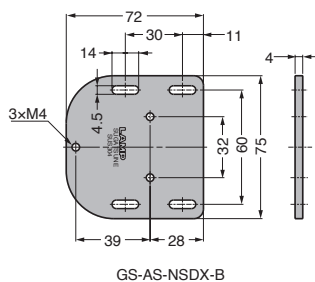
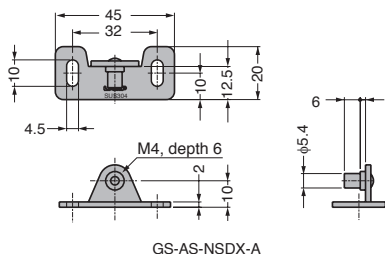
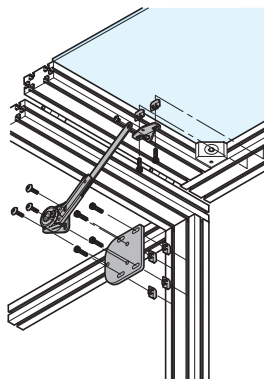

Item Name	Type	Material	Finish	Weight (g)
GS-AS-NSDX-A	For Arm	Stainless Steel (SUS304)	Barrel Polished	15
GS-AS-NSDX-B	For Body			151