

# LID STAY GS-LB-215, GS-LB-290

TEST METHOD 16 L=R SUS

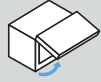

Opening Direction	Description	Non-handed	Qty	Compression Load
 Upward-opening※	Holds When Fully Opened	Yes	1 Unit Per Door 2 Units Per Door	147 N/pc (15 kgf/pc)

※Can also be used for top-opening lid, depending on installation conditions. Please confirm with actual item in detail.

- Holds the lid in fully opened position. Slightly lift up the lid to release stopper.

### [Specifications]

- Appropriate bracket position can be determined depending on door height and opening angle. In this case, ensure that L<sub>2</sub> of the installation example is larger than L<sub>2</sub> shown in the figure below. (Or the hinge and stay may be damaged.)
- Release stopper while supporting the door.
- Calculate suitable door size with reference to LID STAY L SERIES

### [Installation]

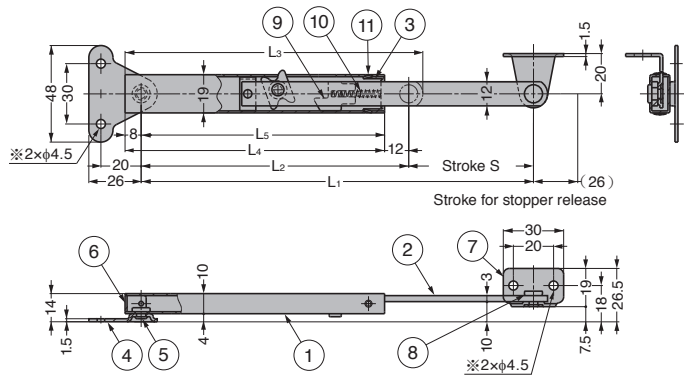
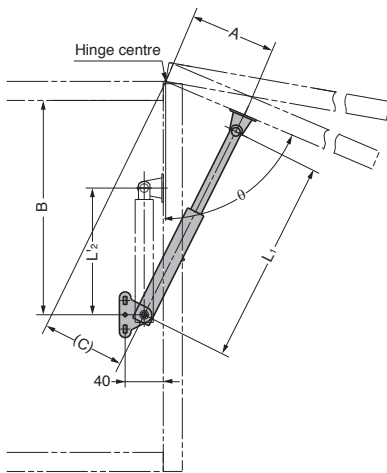
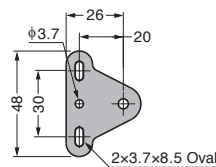
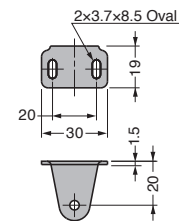

Figure above shows GS-LB-215B or GS-LB-290B.

### Type A Case bracket



### Type A Arm bracket



※Mounting hole shape of GS-LB-215A and GS-LB-290A shown above.

### [Stopper Release]

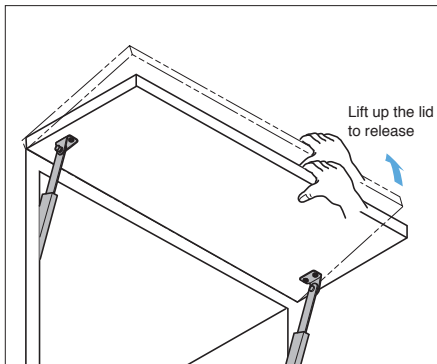

No.	Part Name	Material	Finish
①	Body	Stainless Steel (SUS304)	Satin
②	Arm		-
③	End Cap		Satin
④	Case Bracket		-
⑤	Bottom Shaft	Stainless Steel	-
⑥	Bottom Cap	Stainless Steel (SUS304)	Satin
⑦	Arm Bracket		
⑧	Top Shaft	Stainless Steel	-
⑨	Slide Parts	Zinc Alloy (ZDC)	-
⑩	Spring	Stainless Steel (SUS304)	-
⑪	Blind Rivet	Stainless Steel	-

Item Name	L <sub>1</sub>	L <sub>2</sub>	L <sub>3</sub>	L <sub>4</sub>	L <sub>5</sub>	S	A	B	C	θ	Approx. Door Height	Compression Load N/pc	Compression Load kgf/pc	Weight (g)		
GS-LB-215A	215	153	168	149	141	62	90	225	91.8	67°	260~350	147	15	140		
GS-LB-215B																140
GS-LB-290A																166
GS-LB-290B	290	190	205	186	178	100	105	280	102.9	80°	340~500					166