

# 3/4 EXTENSION SLIDE GS-SNS27S

**LOAD CAPACITY** 176~255 N/pair

**L=R** **SUS**



● 3/4 extension (2 members).

**[Remarks]**

● Be sure to read the "Cautions"

**[Recommended Screws]**

● M4 pan head screw or nominal 4 pan head tapping screw

When closed



When opened

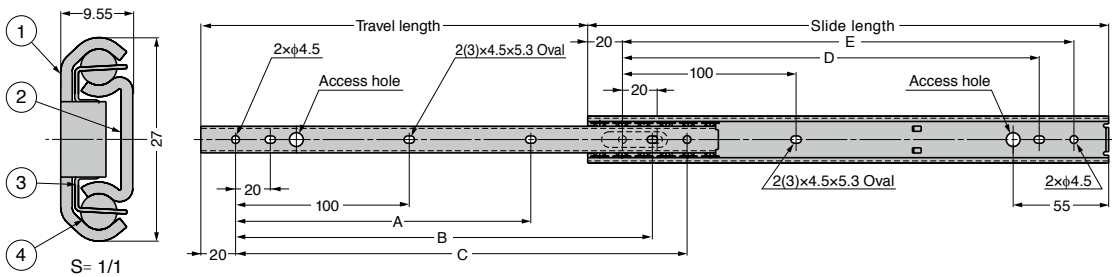

No.	Part Name	Material	Finish
①	Outer Member	Stainless Steel (SUS304)	Plain
②	Inner Member		
③	Retainer	Stainless Steel (SUS440)	-
④	Balls		

Sold by piece.

Item Name	Slide Length	Travel Length	A	B	C	D	E	Load Capacity N/pair	Load Capacity kgf/pair	Weight (kg/pc)
GS-SNS27S-20	200	135	-	140	160	140	160	255	26	0.17
GS-SNS27S-25	250	185	150	190	210	190	210	235	24	0.21
GS-SNS27S-30	300	222	190	240	260	240	260			0.25
GS-SNS27S-35	350	260	225	290	310	290	310	225	23	0.29
GS-SNS27S-40	400	297	265	340	360	340	360	206	21	0.33
GS-SNS27S-45	450	334	300	390	410	390	410	196	20	0.37
GS-SNS27S-50	500	371	337	440	460	440	460	176	18	0.41