

FULL EXTENSION SLIDE GS-ESR4658

LOAD CAPACITY 314~490 N/pair

L=R

DETACH

HOLD CLOSED

SUS



- Full extension (3 members).
- The drawer is detachable by lifting the lever.

[Remarks]

- Be sure to read the "Cautions"
- Some parts of this product are made of plastic.

[Recommended Screws]

- For metal: M4 screw (except for countersunk head)
- For wood: nominal 4 tapping screw (except for countersunk head)

[Easy to Detach]

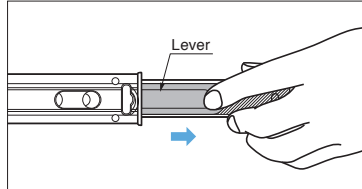

The drawer can be detached by pulling the lever in the direction of the arrow.

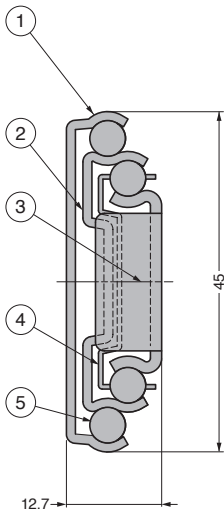

S= 1/1

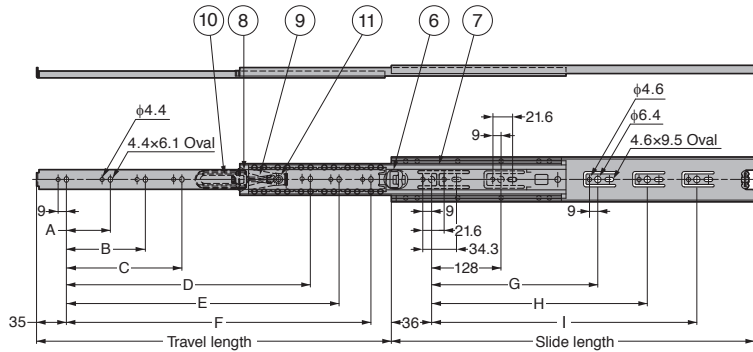

No.	Part Name	Material	Finish/Colour
①	Outer Member	Stainless Steel (SUS304)	Plain
②	Intermediate Member		
③	Inner Member		
④	Retainer		
⑤	Balls		-
⑥	Rubbing Prevention Bumper	PP	Natural
⑦	Retainer	PE	Grey
⑧	Guide Block	PA	Black
⑨	Lever 1	POM	
⑩	Lever 2	PA	
⑪	Rivet	Stainless Steel (SUS302)	-

Sold in pairs (2 pcs).

Item Name	Slide Length	Travel Length	A	B	C	D	E	F	G	H	I	Load Capacity N/pair	Load Capacity kgf/pair	Weight (kg/pair)
GS-ESR4658-14	350	356	-	-	-	-	292	-	-	-	-	490	50	0.99
GS-ESR4658-16	400	406	-	-	-	-	342	-	-	-	-	470	48	1.13
GS-ESR4658-18	450	457	-	-	320	-	392	-	-	-	-	441	45	1.28
GS-ESR4658-20	500	508	-	-	352	-	442	-	-	-	-	421	43	1.42
GS-ESR4658-22	550	559	-	-	-	-	492	-	224	-	-	402	41	1.57
GS-ESR4658-24	600	610	-	-	-	416	542	-	-	-	448	480	39	1.71
GS-ESR4658-26	650	660	-	-	-	-	592	-	-	-	352	353	36	1.86
GS-ESR4658-28	700	711	-	224	-	448	642	-	-	-	544	314	32	2