

STAINLESS STEEL GS-AS NUT Post-installation Type

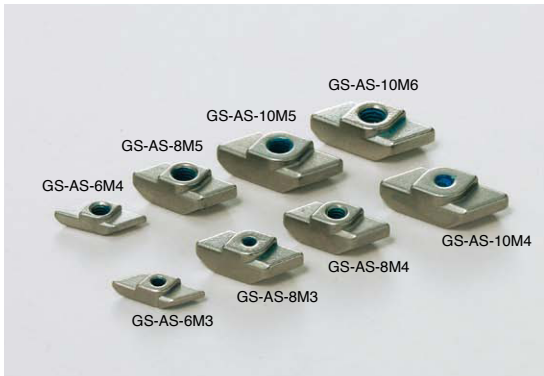

- Used for fixing a part to aluminium frame and makes post-installation possible.
- With coating to prevent looseness of screw.
- Can fix aluminium frame and hardware securely.
- Improved work efficiency with few installation mistakes.
- Widely applied to various aluminium frames.
- Refer to the product page [1](#) for details on GS-AS series.

[Remarks]

- Install with the recommended tightening torque. GS-AS nut not included in the parts set of GS-AS series (for installing to aluminium frame).
- The effect of anti-looseness coating weakens when used repeatedly. Please use at most 2~3 times as a guide.
- Mounting screws not included when ordering single GS-AS nut. Please prepare mounting screws of appropriate length according to aluminium frames.

[Applicable Groove Width]

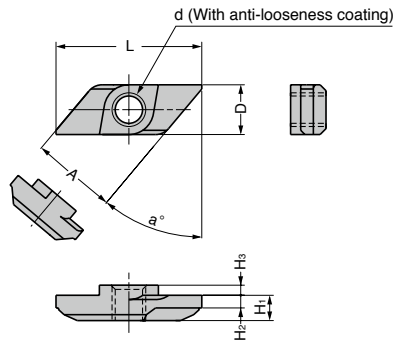
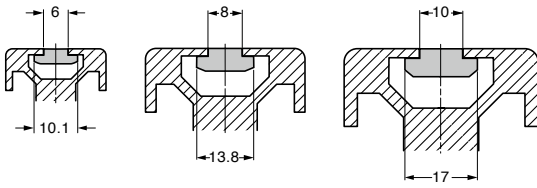

Item Name	Type	d	L	D	A	H ₁	H ₂	H ₃	a	Material	Finish	Recommended Tightening Torque		Weight (g)
												N·m	kgf·cm	
GS-AS-8M3	For 8 mm Groove	M3	20	7.9	13.8	6	3	1.5	32	Stainless Steel (SUS316)	Barrel Polished	0.63~1.14	6.4~11.6	4.3
GS-AS-8M4		M4										1.5~2.7	15.3~27.5	4.1
GS-AS-8M5		M5										3~5.4	30.6~55.1	3.9
GS-AS-10M4	For 10 mm Groove	M4	24	9.8	17	6	3	1.8	32	Stainless Steel (SUS316)	Barrel Polished	1.5~2.7	15.3~27.5	7
GS-AS-10M5		M5										3~5.4	30.6~55.1	
GS-AS-10M6		M6										5.2~9.2	53~93.8	6

[Installation]

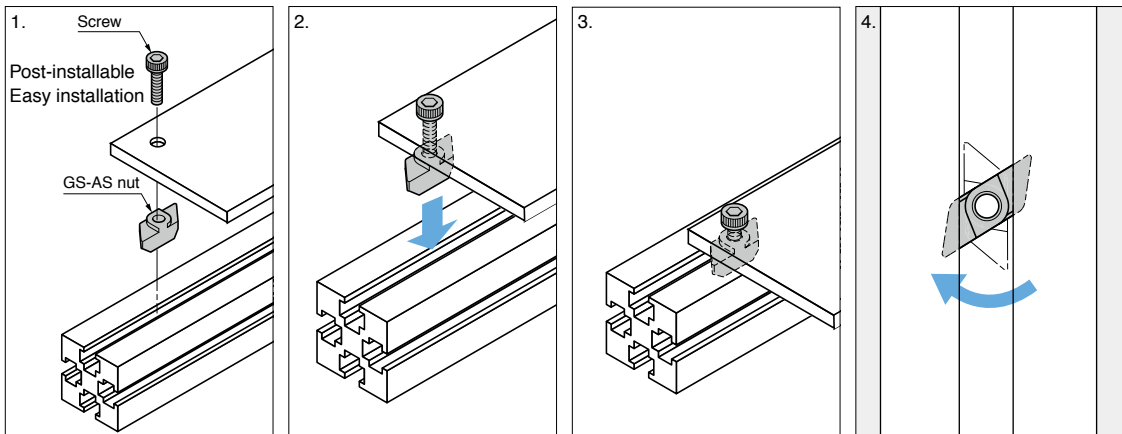

1. Temporarily fix the GS-AS nut to the functional hardware with mounting screw.
2. Insert the GS-AS nut into the groove of the aluminium frame.
3. Make sure that the GS-AS nut is in the groove, and then tighten the screw.
4. When tightening the screw, GS-AS nut rotates and is caught on the aluminium frame and fixes the functional hardware securely.