

TITANIUM HANDLE GS-H-42-CT

TITANIUM

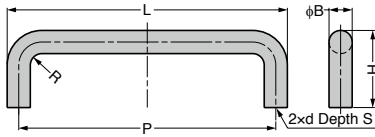

[Recommended Screws]
 ● d × (Door thickness+5~S)

- Ideal for places with light weight and rust resistance requirements.
- Titanium handle hardly causes metal allergy.
- Since it is non-magnetic, suitable for medical devices such as MRI.
- Titanium mounting screws also available.
- Stainless steel handle GS-H-42-C of the same shape also available.

Item Name	Material	Finish	L	H	B	P	R	d	S	Weight (g)
GS-H-42-CT-2	Titanium	Polished	108	30	8	100	4.5	M5	8	37
GS-H-42-CT-4			130	40	10	120	5	M6		59
GS-H-42-CT-15			162	50	12	150	6	M8	10	105