

STAINLESS STEEL CAM LOCK 3800S

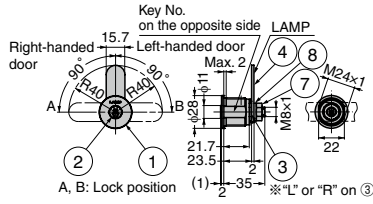

- Nickel silver key with excellent corrosion and abrasion resistance. Durability with thick cam.
- Non-handed.
- Reversible key can be removed when locked (90° rotation). In order to ensure that the application is properly locked.
- 300 key changes available.
- Master Key system (300 key changes) available at surcharge. (1 Master Key only.)
- Cabinet lock 3810S 1 of the same material also available.

[Cut Out Dimensions] [Installation]

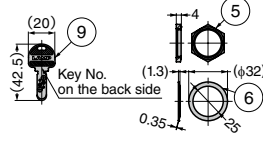
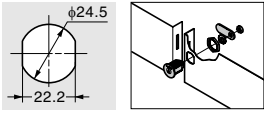

[Remarks]

- Be sure to read the "Cautions" 2.
- Not waterproof.

No.	Part Name	Material	Finish
①	Cylinder (Outer)	Stainless Steel (SUS303)	Satin
②	Cylinder (Inner)		2B Finish
③	Cylinder Cam	Stainless Steel (SUS304)	Plain
④	Cam		
⑤	Nut (for Installing the Body)	Stainless Steel (SUS303)	Plain
⑥	Washer (for Body)	Stainless Steel (SUS304)	
⑦	Nut (for Installing the Cam)	Stainless Steel	Plain
⑧	Washer	Stainless Steel (SUS304)	
⑨	Key	Nickel Silver	
-	Key Ring	Stainless Steel (SUS304)	

*Cylinder pin is made of brass.

[Installing to Right-handed Door]

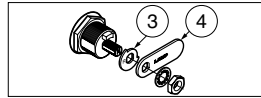

After installation, ensure that the "R" mark on cylinder cam and the "LAMP" mark on cam are in normal direction (as seen from the back of lock).

[Installing to Left-handed Door]

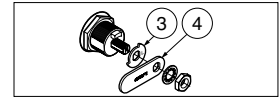

After installation, ensure that the "L" mark on cylinder cam and the "LAMP" mark on cam are reversed (as seen from the back of lock).

RHS	CAD	Item Code	Item Name	Key Type	Door Thickness	Weight (g)	Box (pcs)	Carton (pcs)
G	3D	150-012-921	3800S-B	Key Different	2-10	120	12	60
G	3D	150-001-368	3800S-D	Key Alike			12	60

Refer to 1 : P.866, 2 : P.848

CAM LOCK SN-711-8-D



- Ideal for vending machine, ATM and game machine, etc.
- Reversible key can be removed when locked (90° rotation). In order to ensure that the application is properly locked.
- 1 Key Alike available. For Key Different, Max. 1,500 key changes available by made to order.

[Remarks]

- Be sure to read the "Cautions" 1.

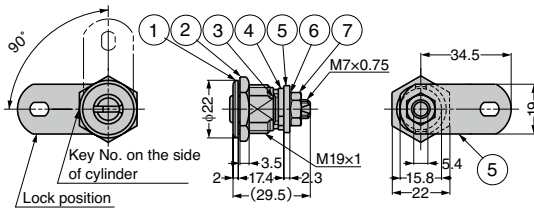

[Cut Out Dimensions]

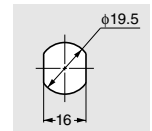

No.	Part Name	Material	Finish/Colour
①	Body	Brass	Chrome
②	Large Hex Nut	Steel	Bright Chromate(Trivalent)
③	Ring	Stainless Steel (SUS304)	Plain
④	Angle Restricting Cam	Steel	Bright Chromate(Trivalent)
⑤	Cam		
⑥	Washer		
⑦	Small Hex Nut		
⑧	Cover	ABS	Black
⑨	Key	Brass	Nickel

RHS	CAD	Item Code	Item Name	Key Type	Door Thickness	Weight (g)	Box (pcs)	Carton (pcs)
G	3D	150-001-391	SN-711-8-D	Key Alike	0.1-9	77	100	400

Refer to 1 : P.848