

STAINLESS STEEL CAM LOCK GS-3800S

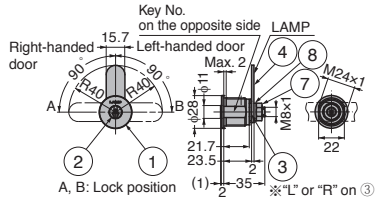

[Cut Out Dimensions] [Installation]

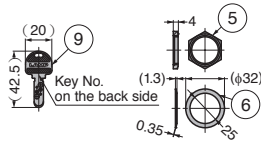
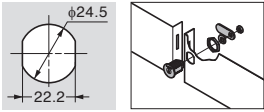

- Nickel silver key with excellent corrosion and abrasion resistance. Durability with thick cam.
- Non-handed.
- Reversible key can be removed when locked (90° rotation). In order to ensure that the application is properly locked.
- 300 key changes available.
- Master Key system (300 key changes) available at surcharge. (1 Master Key only.)
- Cabinet lock GS-3810S of the same material also available.

[Remarks]

- Be sure to read the "Cautions"
- Not waterproof.

No.	Part Name	Material	Finish
①	Cylinder (Outer)	Stainless Steel (SUS303)	Satin
②	Cylinder (Inner)		2B Finish
③	Cylinder Cam	Stainless Steel (SUS304)	2B Finish
④	Cam		
⑤	Nut (for Installing the Body)	Stainless Steel (SUS303)	2B Finish
⑥	Washer (for Body)		
⑦	Nut (for Installing the Cam)	Stainless Steel	Plain
⑧	Washer	Stainless Steel (SUS304)	
⑨	Key	Nickel Silver	
-	Key Ring	Stainless Steel (SUS304)	

※Cylinder pin is made of brass.

[Installing to Right-handed Door]

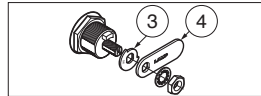

After installation, ensure that the "R" mark on cylinder cam and the "LAMP" mark on cam are in normal direction (as seen from the back of lock).

[Installing to Left-handed Door]

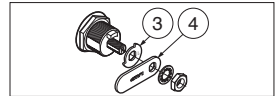

After installation, ensure that the "L" mark on cylinder cam is in normal direction and the "LAMP" mark on cam is reversed (as seen from the back of lock).

Item Name	Key Type	Door Thickness	Weight (g)
GS-3800S-B	Key Different	2~10	120
GS-3800S-D	Key Alike		