

# LOW PROFILE HEAVY DUTY CASTERS **GS-HG** Plate Type

**LOAD CAPACITY 1600~3200 N**



- Small heavy duty type with low profile.
- High performance bearing reduces starting force (GS-HG-50GNB excluded).
- Carburised and quenched main metal parts provide outstanding durability and load capacity.

**[Applications]**

- Medical equipment, automatic equipment, semiconductor equipment, financial equipment, other heavy equipment required for space-saving, long-term fixed heavy equipment, etc.

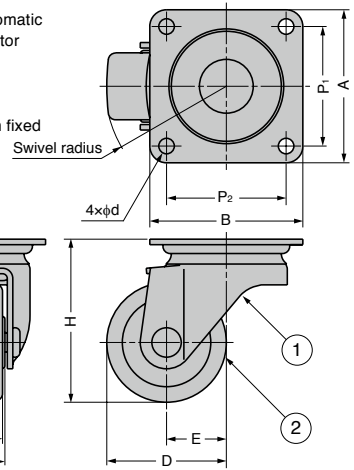

[Reinforced Polyamide Wheel] Item Name Suffix "GNB"



Excellent load capacity and impact resistance compared with polyamide wheel.

[Phenol Wheel] Item Name Suffix "PB"



High surface hardness and excellent resistance against oil, heat and compression.

No.	Part Name	Material	Finish/Colour
①	Body	Steel (SPHC)	Clear Zinc Chromate (Trivalent)
②	Wheel	Item Name Suffix "GNB" : Reinforced (PA) Item Name Suffix "PB" : Phenol Resin (PF)	Black

Item Name	Wheel Material	D	H	E	W <sub>1</sub>	W <sub>2</sub>	A	B	P <sub>1</sub>	P <sub>2</sub>	d	Swivel Radius	Load Capacity N/pc	Load Capacity kg/pc	Weight (g)
GS-HG-50GNB	Reinforced Polyamide	50	68	25	28	30	64	64	50	50	6.5	51	1600	163.2	320
GS-HG-65PB	Phenol Resin (PF)	65	92	22	38	42	90	90	71	71	10.5	57	3000	306	880
GS-HG-75PB		75	106												