

TWIN WHEEL CASTER **GS-GX-W50K** Non-swivel Plate Type

LOAD CAPACITY 1960 N

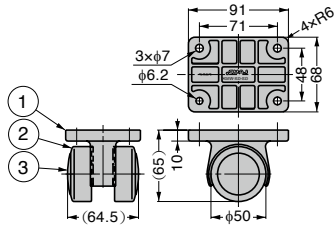

- Stable twin wheel structure provides smooth movement and excellent durability.
- Use in combination with GS-GX-W50GP for easy handling.

No.	Part Name	Material	Finish/Colour
①	Body	Aluminium Alloy (ADC)	Barrel Polished
②	Wheel	POM	Black
③	Cover	PA	

Item Name	Load Capacity N/pc	Load Capacity kgf/pc	Weight (g)
GS-GX-W50K	1960	200	300