

TWIN WHEEL CASTER **GS-GX75P** Plate Type

LOAD CAPACITY 1960 N

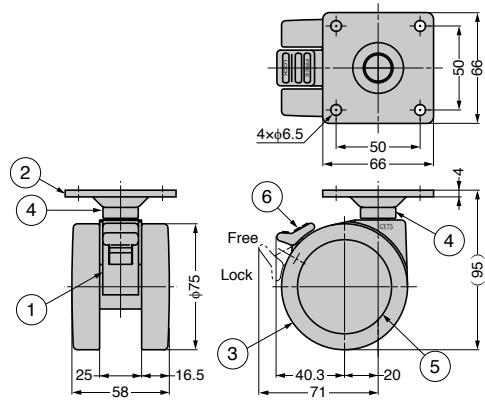

● Stable twin wheel structure provides smooth movement and excellent durability.



Drawing above shows the model with brake.

No.	Part Name	Material	Finish/Colour
①	Body	Aluminium Alloy (ADC)	Barrel Polished
②	Plate	Steel	Coloured Zinc Chromate
③	Wheel	PA	Black
④	Shaft	Steel (SWCH)	Coloured Zinc Chromate
⑤	Cover		
⑥	Lever	PA	Black

Item Name	Type	Load Capacity N/pc	Load Capacity kgf/pc	Weight (g)
GS-GX75PS	With Brake	1960	200	445
GS-GX75P	Without Brake			430