

TWIN WHEEL CASTER **GS-BU-25P** Plate Type

LOAD CAPACITY 392 N



● Wheels are coated in polyurethane which absorbs vibration and gives an extra smooth and quiet movement. Also, unlikely to slip.

[Cross-section Drawing]

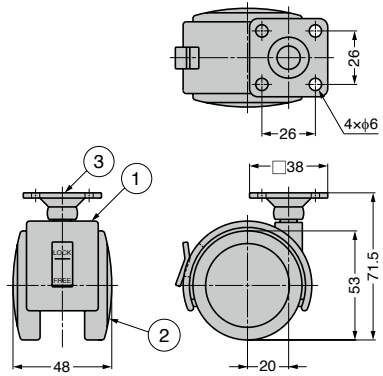
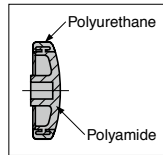

Drawing above shows the model with brake.

Item Name	Type	Load Capacity N/pc	Load Capacity kgf/pc	Weight (g)
GS-BU-25PS	With Brake	392	40	157
GS-BU-25P	Without Brake			150

No.	Part Name	Material	Finish/Colour
①	Body	PA	Black
②	Wheel		
②	Wheel	PUR	
③	Plate	Steel (SPHC)	Clear Zinc Chromate (Trivalent)