

BALL CASTER (RECESSED MOUNT TYPE) GS-BH

LOAD CAPACITY 98~196 N

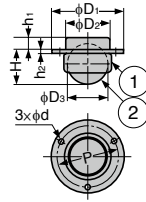

No.	Part Name	Material	Colour
①	Body	Steel (SPCC)	Brass
②	Ball	Steel (SWCH)	Polished

Item Name	D ₁	D ₂	D ₃	H	P	h ₁	h ₂	d	Load Capacity N/pc	Load Capacity kgf/pc	Weight (g)
GS-BH-20	30	18.3	17.5	16	24	5	1.6	2	98	10	35
GS-BH-25	41	24.7	22.2	19.5	36	6	2.3	2.6	147	15	73
GS-BH-32	48	29.3	25.4	24.5	41				196	20	113

[Remarks]

- Dimensions in the figure are for reference.
- Also, steel ball may scratch the floor contact surface. Please confirm the actual item before use.