

PLASTIC CASTER (THREADED BOLT TYPE) GS-NT

LOAD CAPACITY 245 N

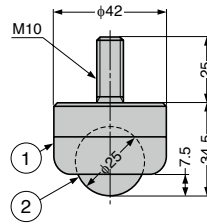

No.	Part Name	Material	Colour
①	Body	PA	Brown
②	Ball	Melamine Resin (MF)	Ivory

Item Name	Load Capacity N/pc	Load Capacity kg/pc	Weight (g)
GS-NT-25	245	25	58

[Remarks]

- Inbuilt ball bearing is made of steel.
- The load capacity is static load value.
- Do not use it on a vertical surface. It may cause noise, deformation or damage.