

STAINLESS STEEL SLIDING DOOR ROLLER GS-JS380 U Type w/o Bracket



- Non-bracket type of GS-JS365
- Bearing with rubber seal (dustproof seal type) provides excellent water resistance.
- Ideal for exterior application.
- 2 bearings are used for wheel diameter above $\phi 150$, providing smooth movement even for heavy doors.

[Applications]

- Gates, etc.

[Remarks]

- The dimension A of wheel diameter $\phi 150$ and $\phi 200$ contains the thickness of supplied washer.

[Parts Included]

- Bolt, nut, spring washer, spacer $\times 2$

[Application Example]

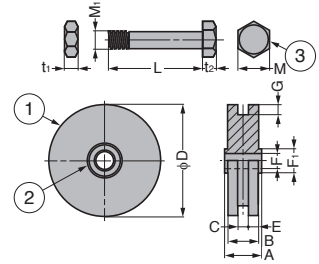
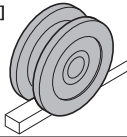

| No. | Part Name | Material | Finish |
|-----|-----------|---------------------------|--------|
| ① | Wheel | Stainless Steel (SUS303) | - |
| ② | Bearing | Stainless Steel (SUS440C) | |
| ③ | Bolt | Stainless Steel (SUS304) | |

| Item Name | D | A | B | C | E | F | F ₁ | G | L | M | M ₁ | t ₁ | t ₂ | Weight (kg) |
|---------------|-----|----|----|------|------|----|----------------|----|----|----|----------------|----------------|----------------|-------------|
| GS-JS380-50H | 50 | 24 | 20 | 7.5 | 6.3 | 10 | 18 | 7 | 40 | 17 | M10 | 6 | 7 | 0.2 |
| GS-JS380-60H | 60 | | | | 0.3 | | | | | | | | | |
| GS-JS380-75H | 75 | | | 0.6 | | | | | | | | | | |
| GS-JS380-90H | 90 | | | 10.5 | 4.8 | | | | | | | | | 0.8 |
| GS-JS380-110H | 110 | 28 | 24 | 14 | 5 | 12 | 20 | 8 | 45 | 19 | M12 | 7 | 8 | 1.5 |
| GS-JS380-150H | 150 | 43 | 43 | 27 | 8 | 20 | 40 | 15 | 75 | 30 | M20 | 12 | 13 | 4.6 |
| GS-JS380-200H | 200 | 50 | 50 | | 11.5 | 25 | | 14 | 92 | | M24 | 14 | 15 | 10 |