

# VENTILATOR **GS-APD-KH** Oval Type with Cable Grommet



- Ventilator and cable grommet in one unit.
- 3 sizes (small, medium, large) and 5 colours available.  
(3 colours for GS-APD-KH260.)

### [Remarks]

- For GS-APD-KH170 and GS-APD-KH260, please use glue for installation.
- Max. exhaust area of the lower cover is the value with no cable passing through.
- Please use glue when installing to sheet metal.

### [Colour Variation]



### [Application Example]

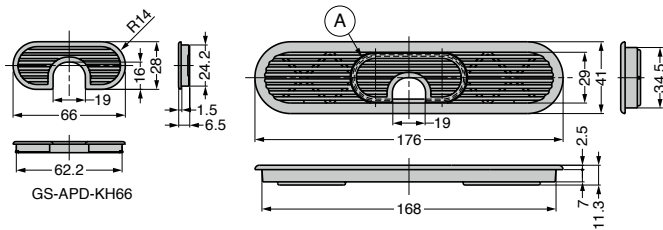
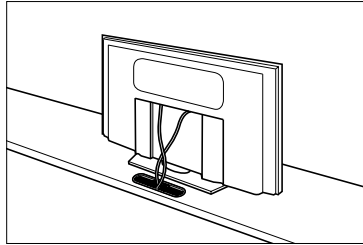

GS-APD-KH66

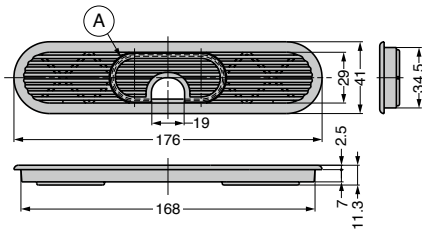

Ⓐ is removable.  
GS-APD-KH170

### [Hole Size (With Ⓐ Removed)]

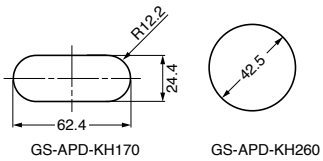

GS-APD-KH170

GS-APD-KH260

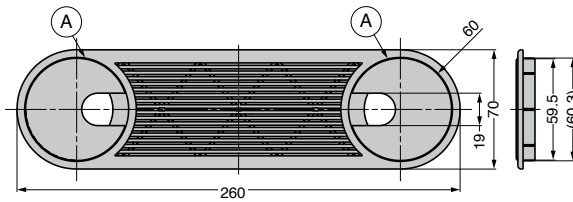

Ⓐ is removable.  
GS-APD-KH260

### [Cut Out Dimensions]

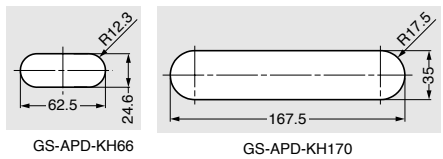

GS-APD-KH66

GS-APD-KH170

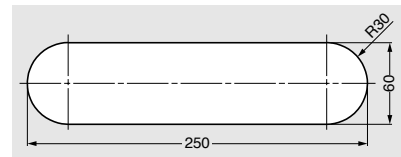

GS-APD-KH260

Item Name	Finish / Colour	Material	Max. Exhaust Area mm <sup>2</sup>	Weight (g)
GS-APD-KH66-CR	Chrome	ABS	610	3.7
GS-APD-KH66-IV	Ivory			3
GS-APD-KH66-BL	Black			
GS-APD-KH66-BR	Brown			
GS-APD-KH66-WT	White			
GS-APD-KH170-CR	Chrome	ABS	1690	
GS-APD-KH170-IV	Ivory			20
GS-APD-KH170-BL	Black			
GS-APD-KH170-BR	Brown			
GS-APD-KH170-WT	White			
GS-APD-KH260-IV	Ivory	ABS	3150	
GS-APD-KH260-BL	Black			
GS-APD-KH260-BR	Brown			