

CABLE GROMMET GS-S70, GS-S91



- For thin cables, slide the part ②
- When taking out cables at both sides, slide part ③ on the left and right sides.
- Cap ④ is removable for wide opening.

[Remarks]

- Be sure to read the "Cautions"
- Since a spring is incorporated in the cap part, the parts may be disassembled. Please be careful when attaching/detaching the cap.

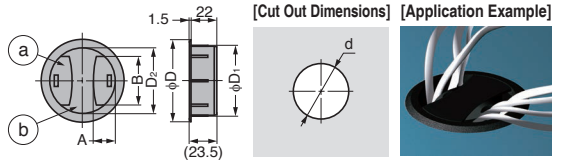
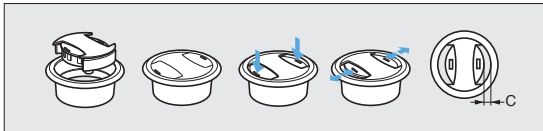

Item Name	Colour	Material	D	D ₁	D ₂	A	B	C	d	Weight (g)
GS-S70W	White	ABS	70.5	60	56	19	41.5	7	60	29
GS-S70CM	Ivory									
GS-S70G	Grey									
GS-S70BR	Brown									
GS-S70B	Black									
GS-S91W	White	ABS	91	80	76	25	55	10	80	39
GS-S91CM	Ivory									
GS-S91G	Grey									
GS-S91BR	Brown									
GS-S91B	Black									